

01/2023

Mod: SBET/XC-20-230V/3-

Production code: 228724 - SPECIALE (230V/3)

TECHNICAL BULLETIN

Doc Nr: PDD2022_13 ed2
Date: 02/02/2023
Issued by: TTS - Product Support

Subject	<u>NEW Software TOUCH 5.5.0 & 5.5.2</u>
Model / PNC / Type reference	All ovens Gas & Electric (Touch screen version): <ul style="list-style-type: none"> • Electrolux Skyline Premium S (Level T), Pro S (Level K) • Zanussi Magistar Combi TS (Level T), Combi TI (Level K) • Diamond (Level T, K) • To Brand (Level T, K) • P codes (prototype ovens) • S codes (special execution ovens) • 190xxx codes
Symptom of fault	
Root cause	
Solution	
Action in Factory	New software in production
Date or s/n of introduction	5.5.0 from Wk. 50-2022 ser 2502000001 5.5.2 from WK 05-2023 ser 3052000001
Action in Field	New software is interchangeable towards all touch ovens in the market; It is recommendable to update the software and related parameters whenever visiting a site. mandatory to update the parameters file too
Spare parts	

TECHNICAL BULLETIN

SOFTWARE UPDATE NOTES 5.5.0

The 7unzipping procedures and an updated “quick guide software update” are inserted into the SERVICE MANUAL (manual code 595404A00).

Main new features of the 5.5.0 SW are:

Automatic drying cycle, that will automatically start when the oven is turned off (pressing button 1/0).

In Parameter

Touch	Digit	Parameter ID	Mnemonic	Short Description	Table	Min	Max	Default
1	1	458	SdrY	Forced drying on switch off	{0, “Disabled”} {1, “Enabled”}	0	1	1

When this parameter is enabled when turning off the appliance an automatic cell drying cycle will be performed.

Once that the green tick has been selected and the door has been opened, on the display will appear a timer of 5 minutes in countdown mode. If the door is not opened or is closed after start of the drying cycle a pop up “open the door” will appear but without a timer, in this case the cycle will last 30min (with door closed and flap open). Oven will turn off at the end of the cycle.

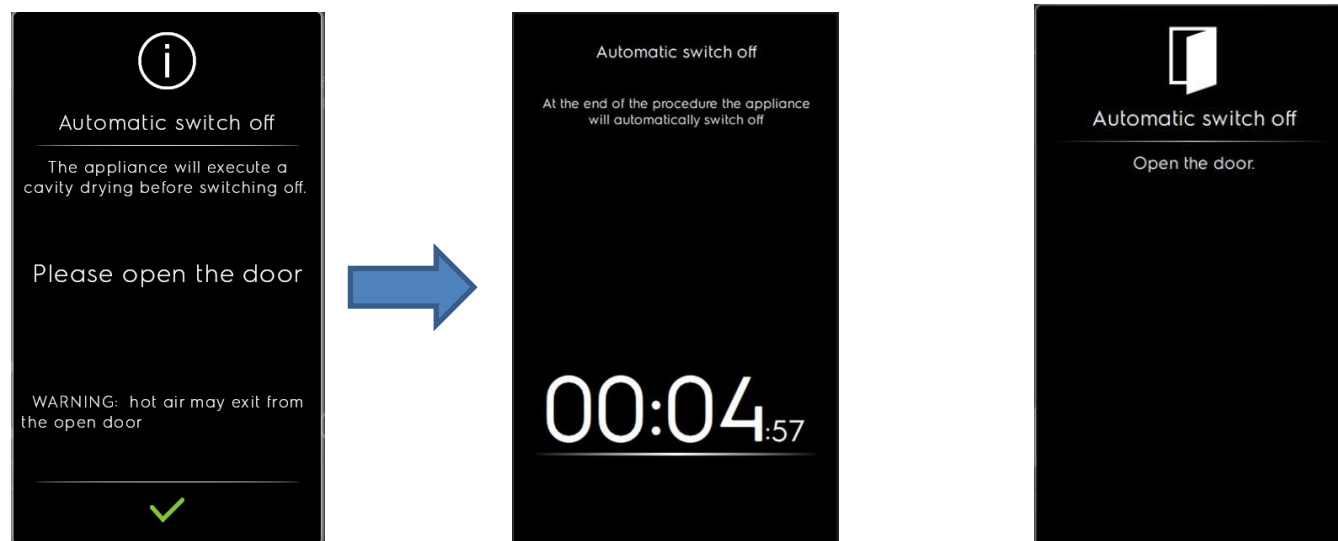

TECHNICAL BULLETIN

Connectivity status icon

An icon is displayed for the connectivity status on the top right corner of the screen, in the top menu area, beside the username (until now only "SERVICE").

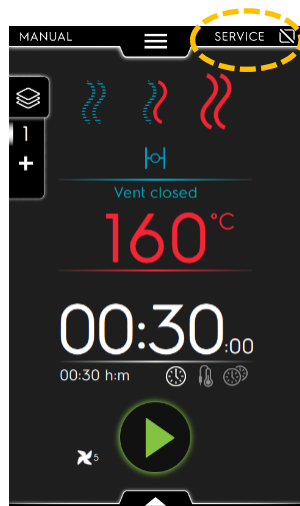

Not connected to connectivity module (NIU or IoT module)



Not connected to LAN Hub (connected to NIU PROE or IoT module but not to hub)



Not connected to Wifi Hub (connected to NIU or IoT module but not to hub)



Connected to hub via LAN but not to cloud



Connected to hub via Wifi but not to cloud



Connected to cloud via Ethernet



Connected to cloud via Wifi. Wifi signal is poor



Connected to cloud via Wifi. Wifi signal is medium



Connected to cloud via Wifi. Wifi signal is good

SW version at start up

The SW version is shown at start up, appearing in the screen.



Introduced with software 5.5.0 onwards, the SW edition numbering.

TECHNICAL BULLETIN

"Only logged" alarms

Some "alarms" will not appear anymore with a popup on the oven display during the event, they will only be "logged" in the dedicated area (Alarms log). Save and send to us the log in case of issue not solved. The following list of "alarms" from now on only logged.

Anomaly N°	Error label	General description
4	SdEr	SD card not working.
240	Bhto	Warning on excessive time on opening operation of the vent valve during cooking (VV1).
241	Bhtc	Warning on excessive time on closing operation of the vent valve during cooking (VV1).
250	EbYP	Quenching thermocouple failure (TQS).
251	Eotd	High temperature on drain (NM8).
293	FSnr	Cooling fan speed not reachable (FAN1-2-3)
294	CFbL	Cooling fan stopped (FAN1-2-3).
304	SbCU	Cavity Up burner fan does not reach set (VTCU).
305	SbCd	Cavity down burner fan does not reach set (VTCD).
306	SbbU	Boiler 1 burner fan does not reach set (VTBU).
307	Sbbd	Error during FRAM memory reading).
312	CSHt	Cavity SSR NTC overtemperature (NHSC).
315	bSHt	Boiler SSR NTC overtemperature (NHSB).
323	ACF	Air filter absent, microswitch AFS
-	H2OL	water leakage

UI "Two touch" mode

This operative mode forces the user to touch at least twice the display in different positions to execute a program. The goal of "two touch" mode interface is to satisfy regulatory requirements for gas appliances and update the "start by closing door" mode.

With this feature enabled the oven starts the cooking cycle when the door is closed and the end condition (timer value or food core temperature) of the first phase. Initially the display shows "----" avoiding the oven to start the cycle when the door is closed. This allows the user to change or update the settings of the phase, adding more phases before starting the cycle.

To start the cycle the user presses "----" the input popup is shown with the default value for the end condition. Confirming the popup, the value is set and the cycle starts.

To enable:

- 1.Settings→Autostart→Switch on "Start cycle by closing door"
- 2.Parameter 459 "2tch" must be enabled, by default is set 0, "Disabled"

"Start by closing door" text change on display when starting cycle

In previous SW editions, in settings -> autostart the text contained a reference to "cooking"; now the text has become: "start cycle by closing the door".

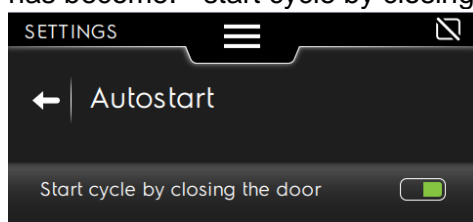

TECHNICAL BULLETIN

Clearer messages for recovery modes

When a recovery mode popup appears, it displays specific messages to give the user hints on what is the effect of its activation. The messages have been improved to facilitate the understanding.

Implemented recovery mode for alarm 228 Hd05

The recovery mode requested for the water solenoid valve EV5 (not working), alarm 228 Hd05 has been implemented.

EV5 is the Boiler fill solenoid, in case it is not working the recovery mode will switch to ISG (instant steam generation) trough EV1 water solenoid valve.

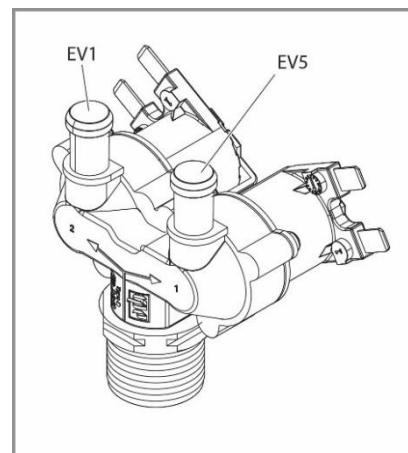

Parameterizable Hood L2/3 management

Level 2 and 3 hoods stay on for some time after the oven goes to idle. This time was fixed to 5 minutes in previous versions. Now it is settable through the 457 HdtL parameter. Its default remains 5 minutes (300 seconds). Default is set 1, "Enabled" 300sec (minimum 0 sec / max 65535 sec)

Modifications to datamonitor

In datamonitor some info on gas burners and lambda probe were missing and the 6 food probe points were shown even with 1-point food probe. Also the water valves status have been reintroduced.

Hoods management in wizard

It is now possible to set the installed hood parameters in the Wizard procedure.

Parameterization of automatic boiler drain

-boiler activation time to trigger boiler drain (par 460 AdAt): default 900seconds, (min 60 sec/ max 3600sec)

-maximum boiler temperature to enable automatic drain (par 461 AdMt): default 50°C (min 30°C/ max 120°C)

-emptying time (par 462 AdEt): default 300sec (minimum 180sec / max 1800 sec)

Review of alarm descriptions

Alarm descriptions of the display popups have been reviewed and updated; they have been improved to facilitate the understanding.

TECHNICAL BULLETIN

Updated water connection description in Wizard

New description:

"Verify water connections. Flow rate and pressure must be consistent with data shown on figure.

Verify the need for a filter after checking the quality of the water, as per the installation manual".

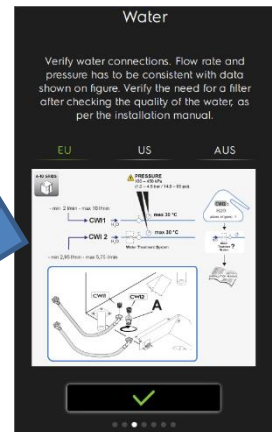

Update to alarms log and popups

Updated the on-screen and on-file alarms log and alarm popup. The update consisted of:

- Log even the alarm reset event
- Log the gas burner blocked events
- Added to datamonitor info of the alarm triggering instant to the alarm log
- Added the possibility to display the technical ID with an icon in the alarm popup
- Display both alarm ID and mnemonic

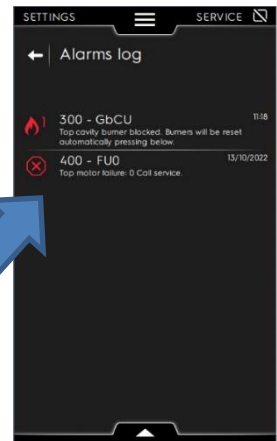

EXAMPLE: Introduced with software 5.5 onwards, the gas burner blockings will also be stored in Alarms log.

New machine log

There is a new machine log, downloadable from the bypass ambient, that replaces the machine logs previously downloadable by that ambient. This log file, whose name is "h-log.txt" contains the main events with a timestamp and a header specifying SW version and memory occupation data.

Example of 7Unzipped LOG files downloaded onto a PC (info regarding the txt files contained can be found in the Service manual 595404A00 ed8)

Name	Date modified	Type	Size
LambdaCalib_2023_01_23_124430.txt	03/02/2023 08:01	Text Document	4 KB
MINMAX20230203.txt	03/02/2023 08:01	Text Document	16 KB
summary.log	03/02/2023 08:01	Text Document	18 KB
Log_20230202_153911_3.log	03/02/2023 08:01	Text Document	10.432 KB
Log_20230202_131144_2.log	03/02/2023 08:01	Text Document	10.432 KB
Log_20230202_104807_1.log	03/02/2023 08:01	Text Document	10.432 KB
Log_20230202_082055_0.log	03/02/2023 08:01	Text Document	10.432 KB
Log.txt	03/02/2023 08:00	Text Document	7.561 KB
h-log_2023_02_03.txt	03/02/2023 08:00	Text Document	157 KB
h-log.txt	03/02/2023 08:00	Text Document	42 KB
Bog.txt	03/02/2023 08:00	Text Document	0 KB

TECHNICAL BULLETIN

Enable hood “US” management

The “US” hood management has been previously disabled. Now it has been enabled back. The management consists of a blocking alarm when its exposed alarm contact triggers.

Add into wizard popup to check and update SW

The following popup is shown during Wizard right after language setting:

TITLE: "Check for software updates"

TEXT: "Before going on please check if there is a newer software version available and update it. Do the same even for other ovens or blast chillers".

Modified text for FW update retry

When a FW update fails, when rebooting the appliance there is a message warning the user that the updated did not end successfully and he can choose to retry it or skip it and launch the software. If no selection is made the appliance loads automatically after a timeout expires.

While waiting for the timeout to expire, in the bottom part of the page there was a message that asked the user to reboot the oven; this text was not correct, because the oven was going to reboot anyway automatically . The text has been modified to : “Loading appliance...”

BUGS FIXED:

Lambda recovery mode

Some changes have been made to this recovery mode:

The parameter 456 LSEn (set default as **normal** ; 0, "Normal" / 1, "Advanced" / 2, "Hidden") determines the mode used to alert the user that the lambda probe is broken can be:

-“**normal**” mode, the ongoing cycle is blocked and the alarm is notified with a pop up in the standard way.

-“**advanced**” and “**hidden**” mode, the ongoing cycle is not blocked and the recovery mode is activated instantly. Furthermore, no alarm popup is displayed.

In the “**advanced**” mode the *ALARM ICON* is displayed and clicking on it the user can view the alarm popup.

In “**hidden**” mode the alarm is not notified to the user in any way during the cycle.

In all the three modes the alarm is registered in the alarm log.

The recovery mode now covers all the possible cycles, even convection with humidity limitation.

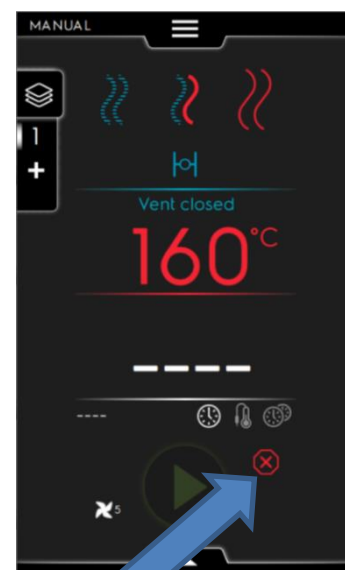

ALARM ICON

SOFTWARE UPDATE NOTES 5.5.2

SW version (5.5.0 / 5.4.0 / 5.1.2 and so on) is available, on our web sites, the “PROGRAMMING FILE” & “PROGRAMMING PARAMETERS” packages version 5.5.2 to update your appliances.

Main new features of the 5.5.2 SW are:

The 5.5.2 is a variant of the 5.5.0 with an improved & implemented Wizard.