

03/2023

# Mod: **SR-UH36FL**

**Production code: 53SRUH36FLXB**

EUROPE

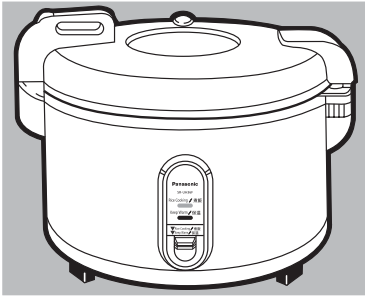

# Operating Instructions

Electronic Rice Cooker / Warmer

---

## Model No. SR-UH36F

---

### Contents

Safety Precautions .....	2-4
Usage Precautions .....	4
Parts Identification .....	5
How to Cook Rice .....	6-7
To Keep Cooked Rice Warm and Tasty .....	7
How to Clean .....	8
Troubleshooting .....	9
Specifications .....	9
Memo.....	34

Thank you very much for purchasing Panasonic product.

**Please give your special attention to "Safety Precautions" on pages 2-4 before use.**

Please carefully read these instructions before use, and keep these instructions for future use.



This appliance is intended to be used in household and similar applications such as:

- staff kitchen areas in shops, offices and other working environments;
- farm houses;
- by clients in hotels, motels and other residential type environment;
- bed and breakfast type environments.



# Safety Precautions

Please follow the instructions below to prevent accident, personal injury, and property damage.

The following charts indicate the degree of damage caused by wrong operation.

	<b>Warning :</b>	Indicates serious injury or death.
	<b>Caution :</b>	Indicates risk of injury or property damage.

The samples of symbols used in this manual are described below.

	These symbols indicate prohibition.
	These symbols indicate requirements that must be followed.

## Warning

**Plug in the AC cord to the outlet firmly.**



(Not doing so can result in an electrical shock or fire due to generation of heat.)

Do not use a damaged plug or outlet.

**Do not plug or unplug the appliance with wet hands.**



(Doing so can result in an electrical shock.)

Do not use wet hands

**Do not place your hands or face over or near the steam vent.**



(Exposure to steam can cause personal injury.)

Do not touch

**Do not damage the AC cord or plug.**



Prohibited

Do not disassemble, expose to heat or fire, twist, pull, place heavy objects on or tie the AC cord in a bundle.

(A damaged cord or plug can lead to electrical shock or fire.)

If the AC cord or plug is damaged, consult your nearest retailer or service center for repair.

**Do not insert metal objects such as pins or needles, or any other objects in the exhaust outlets, or in any other portion of the unit.**



Prohibited

(Doing so can lead to an electrical shock or malfunction.)



(It may result in a burn or injury.)

This appliance can be used by persons with reduced physical, sensory or mental capabilities or lack of experience and knowledge if they have been given supervision or instruction concerning use of the appliance in a safe way and understand the hazards involved.

**Children shall not play with the appliance.**

**Clean the power plug regularly.**



(Dust accumulation can lead to fire or a malfunction.)

Unplug and wipe with a dry cloth.

**Do not operate the appliance with damaged AC plug or cord.**



Prohibited

(It may result in an electrical shock or fire.)

**Be sure the supply voltage matches the required voltage of the appliance.**



(It may cause electrical shock or fire.)

# Safety Precautions



## Warning

**Stop using the appliance immediately when abnormality or breakdown occurs.**

(It may cause smoking, a fire or electric shock.)



e.g. for abnormality or breaking down:

- **The Power Plug and the Power Cord become abnormally hot.**
- **The Power Cord is damaged or power failure when it is touched.**
- **The Main Body is deformed or is abnormally hot.**
- **There are cracks, looseness or wobbles of the appliance.**

**Please consult your nearest retailer or service center for a check or repair immediately.**

**If the Power Cord is damaged, it must be replaced by the manufacturer, its Service Agent or similarly qualified person in order to avoid a hazard.**



(Otherwise, it may cause a fire, electrical shock or injury.)

**Do not modify, disassemble or repair the appliance.**

(It may cause a fire, electrical shock or injury.)

Please consult your nearest retailer or Service Center.



Do not disassemble.

This appliance can be used by children aged from 8 years and above if they have been given supervision or instruction concerning use of the appliance in a safe way and if they understand the hazards involved. Cleaning and user maintenance shall not be made by children unless they are older than 8 and supervised. Keep the appliance and its cord out of reach of children aged less than 8 years.



(It may result in a burn or injury.)

**Do not immerse the appliance in water or other liquids.**



(It may cause an electrical shock or short circuit.) If water gets inside the appliance, please consult your nearest retailer or Service Center.



## Caution

**Do not operate the appliance near water, near a heat source, or expose to high humidity.**



Prohibited

(Doing so can lead to an electrical shock or fire.)



Do not touch

**Do not touch heating elements while the appliance is in use or after cooking. Especially the lid, inner pan and sensor.**

(Doing so can lead to personal injury.)



**Allow the appliance to cool before cleaning.**



(Touching hot elements may cause a burn.)

**Do not place the appliance on uneven surfaces or non-heat-resistant carpets.**



Prohibited

(It may overturn causing personal injury or resulting in a fire.)

**Do not hold the handle or press on the lid release button when carrying or moving the appliance.**



Do not touch

(The lid may open and the appliance may fall causing injury or damage.)

# Safety Precautions



## Caution

**To prevent electric shock, be sure to grasp the plug itself when disconnecting it; never unplug by pulling the AC cord.**



(Pulling the cord may damage the cord resulting in an electric shock.)

**Do not place the appliance near a wall or furniture.**



Prohibited

(The steam may cause color changes or deformation of any nearby objects.)

**Do not substitute the inner pan with other containers.**

※ Do not use damaged inner pan with the rice cooker. Please contact authorized service agent for replacement.



Prohibited

(It may cause a burn or injury due to overheat or malfunction.)

**Unplug the power plug from the power outlet when the appliance is not in use.**



Unplug

(Otherwise it may cause an electric shock and fire caused by a short circuit due to the insulation deterioration.)

# Usage Precautions

## Avoiding damage to the appliance.

**Do not cover the outer lid with a cloth.**

The outer lid may become deformed, cracked or discolored and result in malfunction.

**Do not place the appliance in direct sunlight.**

**Do not use the inner pan for other applications.**

**Please always clean the foreign objects such as rice on the pan, cast heater and sensor.**

Otherwise, it may result in malfunction of the unit.

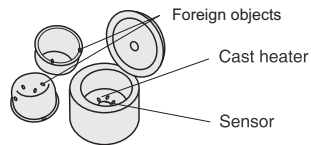

## Avoiding damage to the inner pan.

**Do not leave the rice scoop or any other objects inside the inner pan.**

The inner pan should be cleaned immediately after cooking.

**Do not use the inner pan as mixing utility.**

**Do not use metal utensils that can scratch or crack the inner pan.**

The coated surface of the inner pan will gradually wear away, so use with care.

**Do not tap or rub the inner surface of the inner pan. Clean only with a sponge or soft cloth. Do not use a scouring pad.**

# Parts Identification

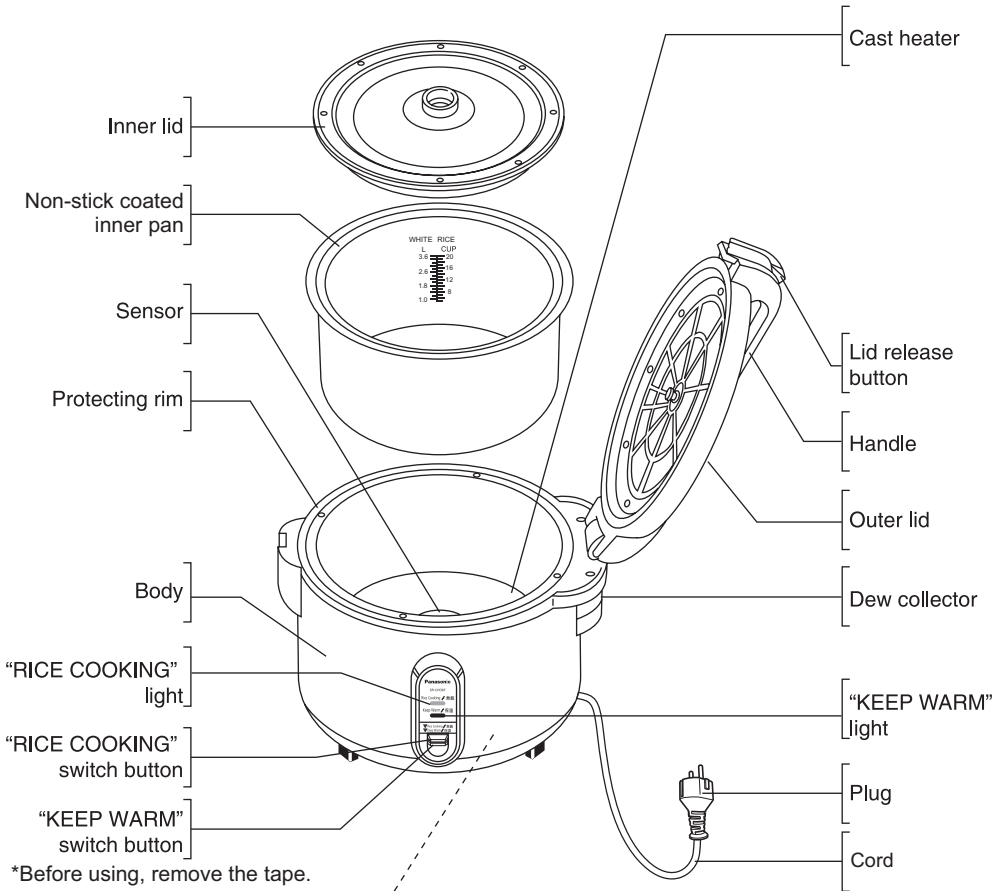

Before using, remove the sheet of paper placed between the cast heater and inner pan.

If the supply cord is damaged, it must be replaced by the manufacturer, its service agent or similarly qualified persons in order to avoid a hazard.

## Accessories



Measuring cup  
(approx. 180 mL)  
(1 pc.)



Rice scoop  
(1 pc.)



Scoop holder  
(1 pc.)

## Removal and attachment of scoop holder

- Attachment  
Face the magnet of the scoop holder towards the body of the rice cooker and gently attach the surface, anywhere available.
- Removal  
Slide the scoop holder upward and pull it off. Do not attempt to forcibly pull the scoop holder off the rice cooker body since this could cause surface damage.

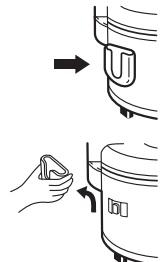

# How to Cook Rice

1

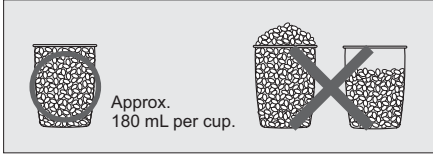

Measure the rice using the measuring cup provided.

2

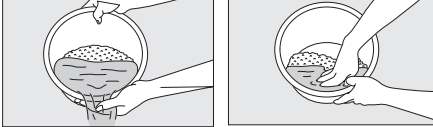

Add plenty of water, stir, and quickly drain the water.

Rinse and wash the rice until the water becomes relatively clear.

Rinse the rice

Do not rinse the rice by using the inner pan.

Rinse the rice in a separate bowl. Do not rinse the rice in the provided inner pan as non-stick coating may be damaged. Pour the washed rice into the inner pan.

3

e.g. To cook 15 cups of rice :

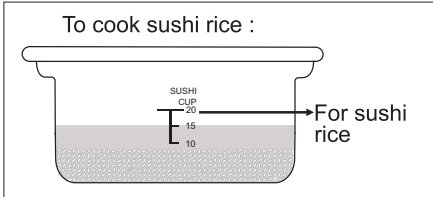
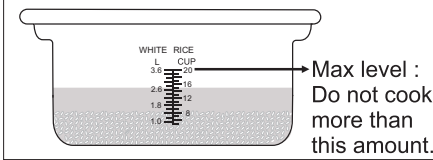

Pour in the desired amount of water

Set the inner pan on a flat surface when adding the water.

Add water according to the level indication. (When cooking sushi rice, use the level indication for sushi rice.)

Add water to the corresponding level, and then adjust to suit your taste. (Do not increase the water more than 1/4 cup of water.)

Hot water is not recommended for cooking as it may result in soggy rice.

4

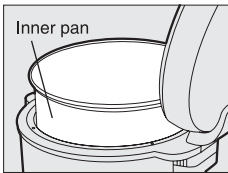

Put the inner pan into the body.

Wipe water off around the surface of the inner pan before placing into a rice cooker, otherwise it may result in strange noise during cooking.

Be sure that the inner pan is directly in contact with the cast heater. Improper contact between the inner pan and the cast heater may result in uncooked rice.

Be also sure that the inner lid is attached to the outer lid.

5

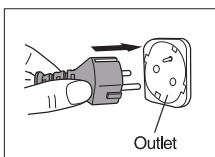

Plug in the AC cord to the power supply outlet.

Close the outer lid, plug in the AC cord to the power supply outlet.

Close the outer lid firmly. (If it is not securely closed, cooking will be affected.)

# How to Cook Rice

6



Press the switch to start cooking.



The "RICE COOKING" light lights up.

## Press switch.

Do not open the outer lid or unplug the appliance while it is operating. Please ensure that the switch is pressed and the "RICE COOKING" light lights up properly. (The rice will not be cooked in warming mode.)

7



The "KEEP WARM" light lights up to indicate warming mode.

## After the rice is cooked, it is recommended to let it steam and warm for another 15 minutes. Then scoop and mix the rice well.

After the rice is cooked, the appliance will automatically switch to warming mode. Let the rice steam and warm for another 15 minutes without opening of the outer lid. Scoop and mix the rice well. Unplug the appliance when it is not in use.

English

# To Keep Cooked Rice Warm and Tasty

- After the rice has been steamed and warmed, scoop and mix the rice gently. Do not leave the rice scoop inside the inner pan.
- Do not warm the rice for more than 12 hours. (It may cause a smell or discoloration.)
- Do not use the rice cooker to warm other kinds of food. It is for rice only.
- Do not warm cold rice.

### Note:

- Variations in the room temperature may cause the rice to discolor and lose its fresh smell.
- Unplug the rice cooker when it is not be used.
- Clean the dew collector located on the side of the rice cooker by pouring out the water, cleaning and sanitizing it after every use.

# How to Clean

- Before cleaning, please pull out the power plug first. Do not clean the rice cooker until it cools down.
- DO NOT use objects such as benzine, thinner, cleansing powder or metal scrubbers.

## Inner lid / Inner pan

Wash with a dishwashing detergent and soft sponge. Wipe off any moisture on the outside of the inner pan.

\*Note : Clean after every use.

## Body / Outer lid / Protecting rim

Wipe with a damp cloth.

## Cast heater

If any objects stick on the bottom of the pan or cast heater, remove them immediately.  
Object, such as rice or other food debris may cause a malfunction and damage.

## Dew collector

Remove, clean and sanitize after every use.

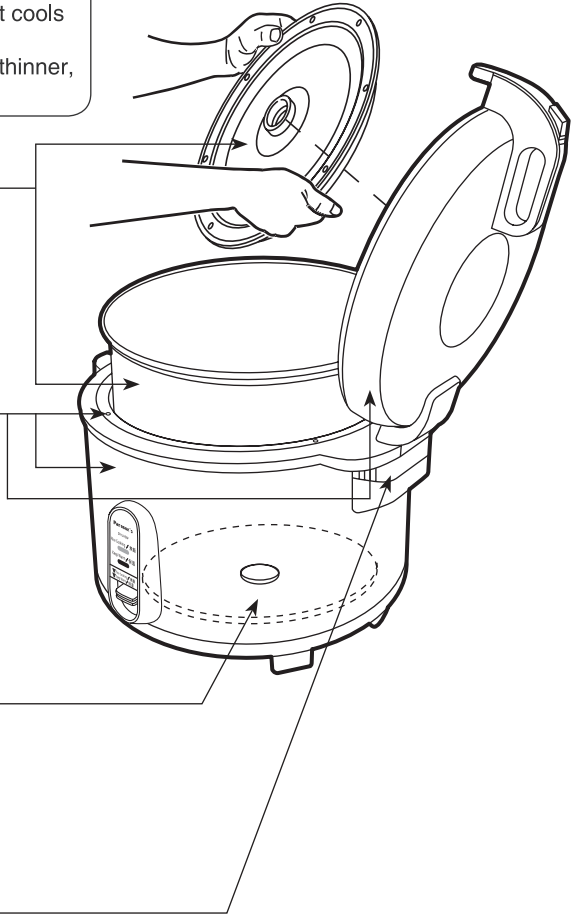

## Accessories



Measuring cup



Rice scoop



Scoop holder

Wash with sponge and dishwashing liquid after use.

# Troubleshooting

Check Items	Rice cooking					Keep warm			No reaction to any switch operation	Produces a strange sound
	Too hard	Uneven cooking (The core of rice remains),	Too soft	Viscous juice overflows	Burnt rice at the bottom of the inner pan	Rice produces an odor	Changes in color	Gets too dry		
• Are the volume of rice and the volume of water correct?	●	●	●	●	●				● No current supplied. Pull out the plug and check the breaker.	● "Pang" sound produced during cooking is the sound of bursting of water drops under the action of thermal expansion on the bottom (outside) of the inner pan.
• Is the rice rinsed adequately?				●	●	●				
• Is the bottom of the inner pan dented?	●	●			●					
• Is there any foreign matter sticking to the outside of the inner pan or the sensor?	●	●	●		●	●	●			
• Is the rice being cooked with oil?	●	●				●				
• Has the rice been well fluffed after cooking?	●		●							
• Is the keep warm continuing for more than 12 hours?						●	●	●		
• Is the too small amount of rice kept warm?										
• Is the Keep Warm being used with the scoop in it?						●				
• Is the Keep Warm setting being used on cold rice?						●				
• Is the outer lid securely closed?				●		●		●		
• Is the inner pan clean?					●	●				
• AC cord unplugged or switched turned off during rice cooking?		●				●				

# Specifications

<b>Model No.</b>		<b>SR-UH36F</b>
<b>Power supply</b>		230 - 240 V ~ 50 Hz
<b>Power consumption</b>	<b>During cooking</b>	1400 - 1524 W
	<b>During keep warm</b>	124 W
<b>Capacity</b>		1.0 - 3.6 L (5 - 20 cups dry rice)
<b>Weight (approx.)</b>		17.6 lbs (8.0 kg)
<b>Dimensions (HxWxD) (approx.)</b>		34.7 cm x 42.8 cm x 38.4 cm
<b>Accessories</b>		Measuring cup, Rice scoop, Scoop holder

