



# **MOD : GTP-5/2R**

**Production code : LF05DD-M24R**

Jet engine compressor drawings

Creative  
MARKET

**01/2026**

PIEGHE IN GIU'  
 -----  
 PIEGHE IN SU'

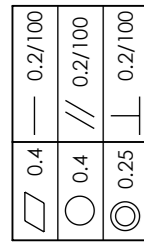

Angles ± 1°  
 Angoli ± 1°

General tolerance - Tolleranza generale: UNI EN 227 68/1 - C	
Length and diam. Lung. e diametri	> 4000 2000 1000 315 120
Tolerance Tolleranza	± 0.2 ± 0.5 ± 0.8 ± 1.2 ± 2.0 ± 3.0 ± 4.0 ± 5.0

A3

<b>Modello / model</b>		<b>LF05DD-M24R</b>	
<b>dimensioni</b>	<b>LxPx mm</b>	<b>790x700h875</b>	
<b>larghezza luce porta</b>	<b>mm</b>	<b>680</b>	
<b>altezza luce porta</b>	<b>mm</b>	<b>380</b>	
<b>profondità interna</b>	<b>mm</b>	<b>415</b>	
<b>SPESORE COIBENTAZIONE</b>	<b>mm</b>	<b>60</b>	
<b>classe climatica</b>		<b>4</b>	
<b>capacità abbattimento</b>	<b>kg</b>	<b>18</b>	
<b>capacità congelamento</b>	<b>kg</b>	<b>12</b>	
<b>refrigerante</b>	<b>gas</b>	<b>R290</b>	
<b>capacità refrigerazione 1)</b>	<b>W</b>	<b>1416</b>	
<b>alimentazione elettrica</b>	<b>V/Hz</b>	<b>230/1/50</b>	
<b>potenza elettrica</b>	<b>W</b>	<b>815</b>	
<b>corrente max</b>	<b>A</b>	<b>4,6</b>	
<b>allestimento catering</b>		<b>5 GN 1/1</b>	
<b>allestimento baking</b>		<b>5 EN 600x400</b>	
<b>passo teglie</b>	<b>mm</b>	<b>65</b>	
<b>peso netto</b>	<b>kg</b>	<b>75</b>	
<b>cavo elettrico</b>	<b>mm²</b>	<b>3x1,5</b>	
<b>tubo scarico acqua</b>	<b>Ø</b>	<b>1/2"</b>	
<b>sbrinamento</b>		<b>automatico a sost</b>	
<b>controllo ciclo : a tempo</b>		<b>si</b>	
<b>controllo ciclo : a spillone</b>		<b>si</b>	
<b>1) temp.evap. -10°C , temp.cond. +45°C</b>			

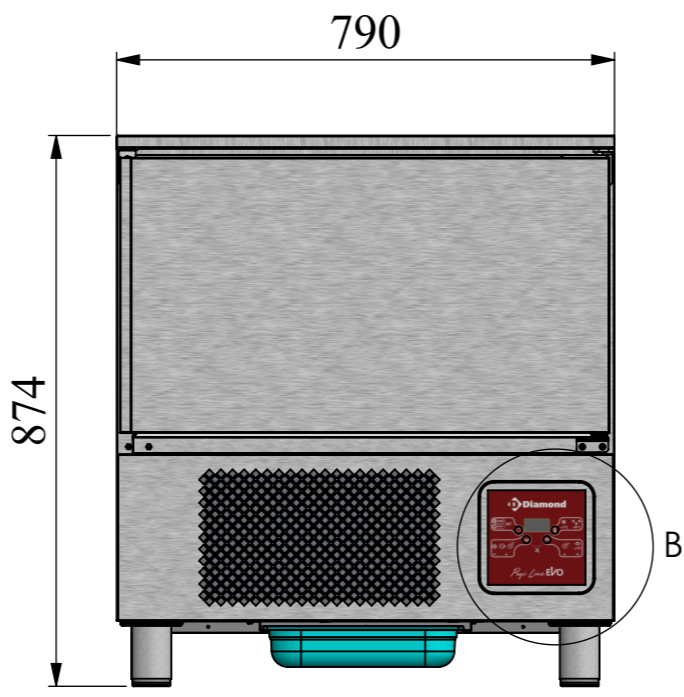

DETTAGLIO B  
 SCALA 1 : 6

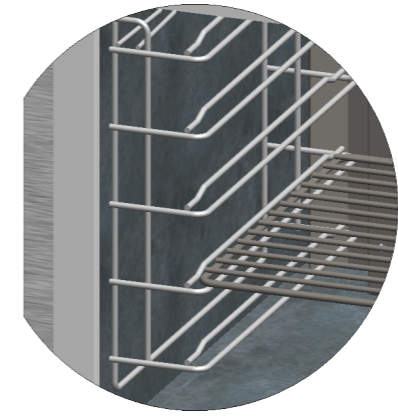
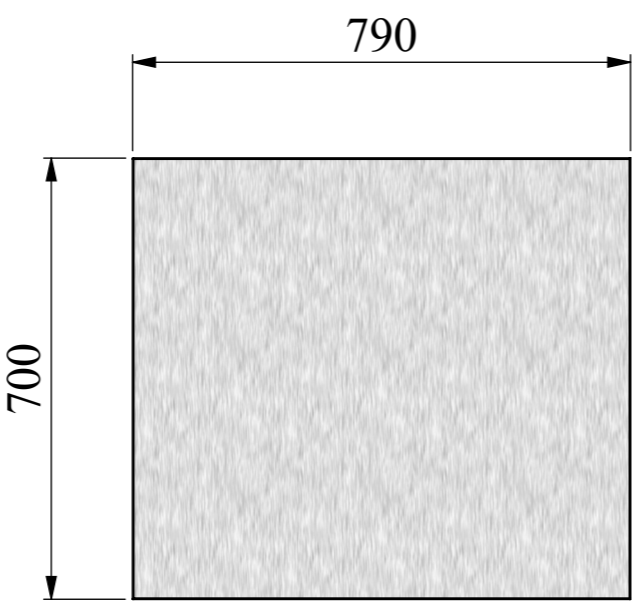
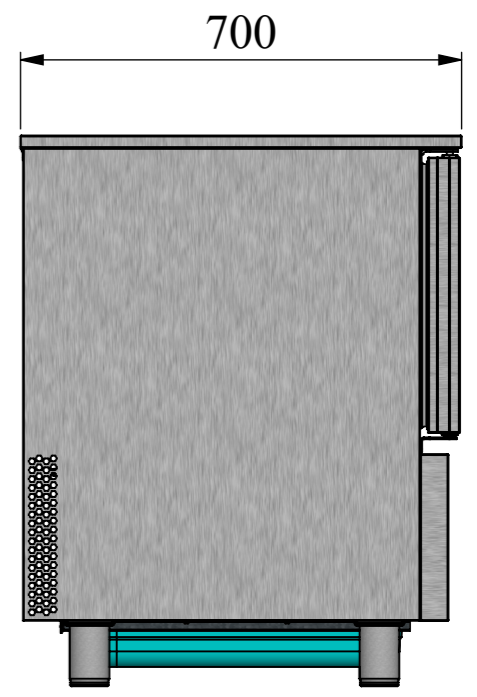

DETTAGLIO A  
 SCALA 1 : 6

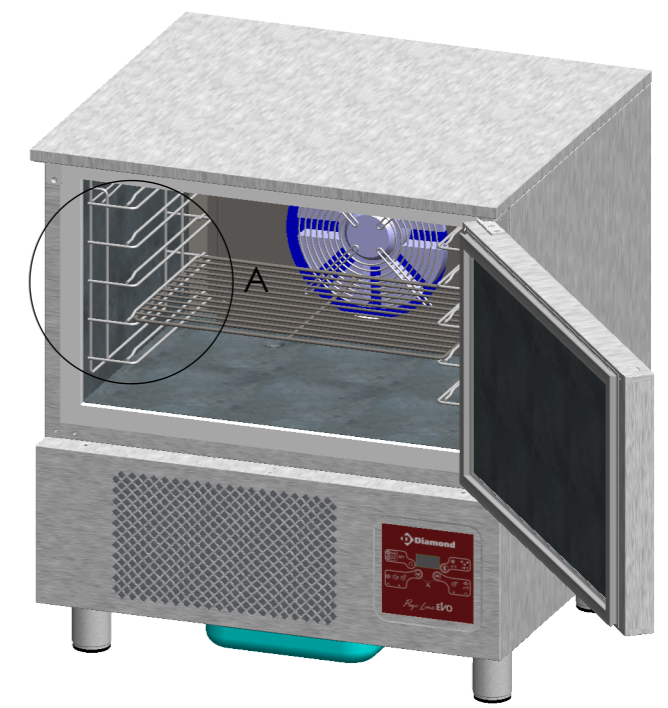

<b>Diamond</b>		<b>DIAMOND EUROPE</b>	FINITURA/Finish	<b>SB</b>	PESO/Weight (kg)
Chaussée de Vilvorde 92		<b>RIFERIMENTO / Reference</b>			
Brussels - Belgium		<b>GTP-5/2R</b>		SCALA/Scale	DATA/Date
DENOMINAZIONE/Name				<b>1:12</b>	<b>30/10/25</b>
<b>BLAST CHILLER 5T DIGIT R290</b>			GREZZO/Stock size	ORIENTAMENTO	
			<b>mm</b>		
				FIRMA/Sign	
				<b>MG</b>	
				REV/Rev	
				<b>00</b>	

Il presente disegno è proprietà della Diamond Non può essere copiato o mostrato a terzi senza preventiva autorizzazione scritta. La Società tutelerà a termini di legge.  
 This drawing is property of Diamond an may not be reproduced nor disclosed to third parties without the written consent of Diamond Any abuse will be prosecuted.

This drawing contains confidential information and is the property of DIAMOND, without whose permission it may not be copied, shown or handed to a third party or otherwise used, and it is to be returned promptly upon request to the DIAMOND, which is responsible for the drawing. SUPPLY SPECIFICATIONS / SPECIFICHE DI FORNITURA  
Remove all punching burrs after machining or press-forming process. draft angle 2°  
fillets not quoted R=2, internal bend radius as thickness. chamfers not quoted: 0.5x45°  
For other specifications please contact the technical Department.

	0.4	—	0.2/100
	0.4	//	0.2/100
	0.25	⊥	0.2/100

Angles ± 1°  
Angoli ± 1°

General tolerance - Tolleranza generale: UNI EN 227 68/1 - C	
Length and diam. Lungh. e diametri	>
0,00 6,00 30,0 120 315 1000 2000 4000	0,00 6,00 30,0 120 315 1000 2000 4000
Tolerance Tolleranza	± 0.2 ± 0.5 ± 0.8 ± 1.2 ± 2.0 ± 3.0 ± 4.0 ± 5.0

PIEGHE IN GIU'  
PIEGHE IN SU'

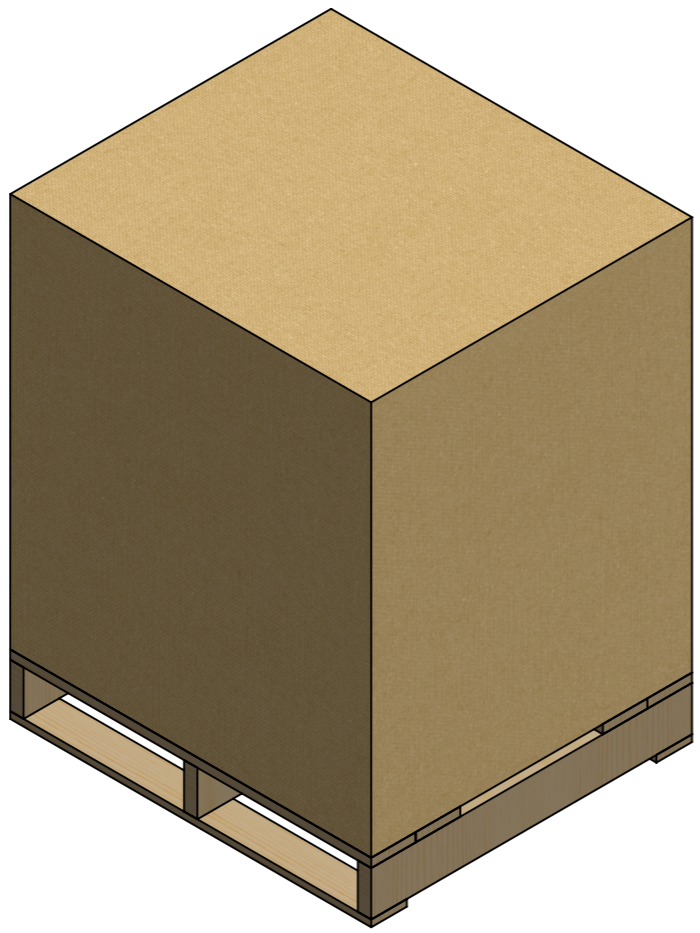
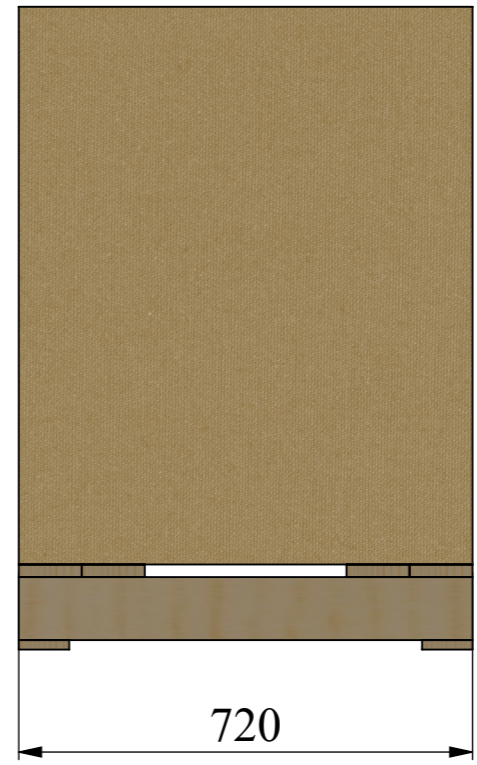
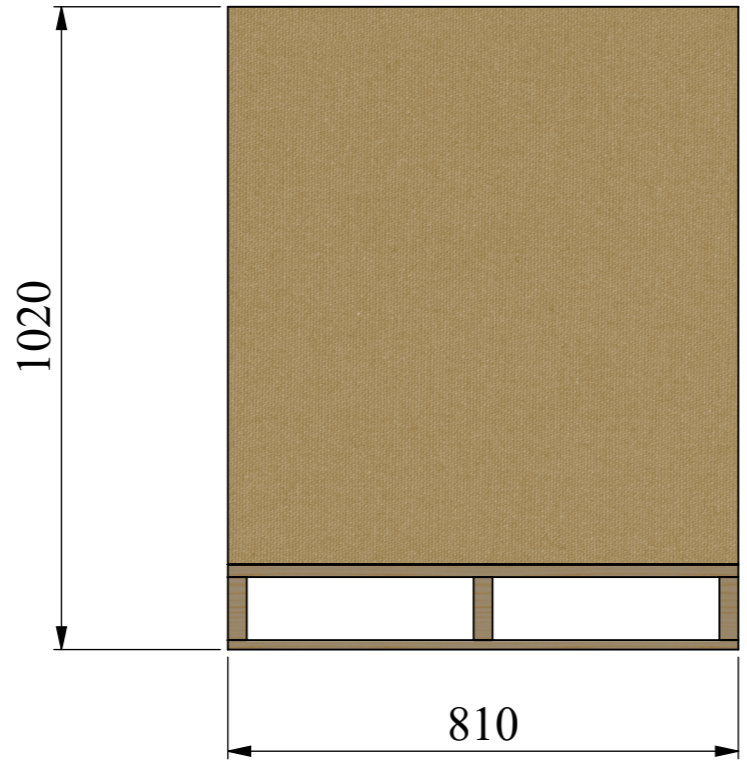

DIMENSIONI  
L=810 P=720 H=1020

PESO LORDO 100KG  
PESO NETTO 75KG  
VOLUME 0,6 MC

DIMENSIONS  
L=810 P=720 H=1020

GROSS WEIGHT 100KG  
NET WEIGHT 75KG  
VOLUME 0.6 MC

<b>Diamond</b> Chaussée de Vilvorde 92 Brussels - Belgium DENOMINAZIONE/Name <b>BLAST CHILLER 5T DIGIT R290</b>	<b>DIAMOND EUROPE</b> SA/NV RIFERIMENTO / Reference <b>GTP-5/2R</b>	FINITURA/Finish <b>SB</b>		PESO/Weight (kg)
		GREZZO/Stock size <b>mm</b>	SCALA/Scale <b>1:12</b>	DATA/Date <b>30/10/25</b>
<small>Il presente disegno è proprietà della Diamond Non può essere copiato o mostrato a terzi senza preventiva autorizzazione scritta. La Società tutelerà a termini di legge. This drawing is property of Diamond and may not be reproduced nor disclosed to third parties without the written consent of Diamond Any abuse will be prosecuted.</small>			ORIENTAMENTO 	FIRMA/Sign <b>MG</b>
				REV/Rev <b>00</b>

PIEGHE IN GIU'  
PIEGHE IN SU'

This drawing contains confidential information and is the property of DIAMOND, without whose permission it may not be copied, shown or handed to a third party or otherwise used, and it is to be returned promptly upon request to the DIAMOND, which is responsible for the drawing. SUPPLY SPECIFICATIONS / SPECIFICHE DI FORNITURA. Remove all punching burrs after machining or press-forming process. draft angle 2° fillets not quoted R=2, internal bend radius as thickness, chamfers not quoted: 0.5x45°. For other specifications please contact the technical department.

—	0.2/100
//	0.2/100
□	0.4
○	0.4
◎	0.25

Angles ± 1°  
Angoli ± 1°

General tolerance - Tolleranza generale: UNI EN 227 68/1 - C	
Length and diam. Lung. e diametri	> 315 1000 2000 4000
Tolerance Tolleranza	± 0.2 ± 0.5 ± 0.8 ± 1.2 ± 2.0 ± 3.0 ± 4.0 ± 5.0

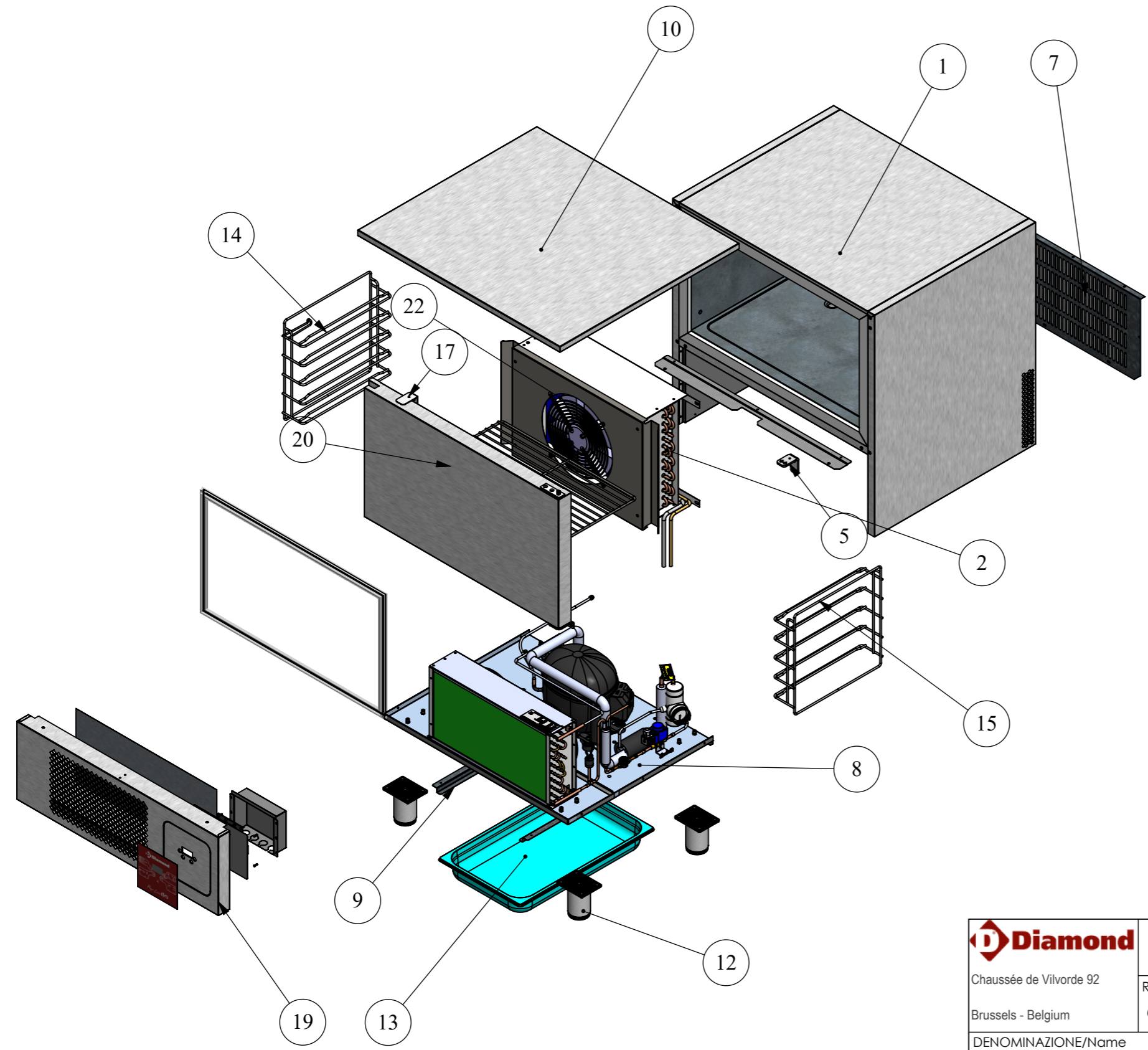

Num. articolo	Codice	Descrizione	QUANTITA'
1	LV009762_00	CORPO SCHIUMATO 5 TEGLIE	1
2	4101-0352	EVAPORATORE 42T 14T.3R-450.PA-4,5	1
3	LV009742_00	ALLINEATORE CRUSCOTTO	1
4	LV000187_00	INSERTO M4 CH6 TESTA RIDOTTA	2
5	LV009670_03	CERNIERA SUPERIORE PIVOT	1
6	LV009757_00	CERNIERA INFERIORE	1
7	LV009743_00	GRIGLIA POSTERIORE	1
8	LV009737_01	BASAMENTO GRUPPO	1
9	LV009740_00	GUIDA BACINELLA	2
10	LV009745_00	TOP X 5 TEGLIE SP20	1
11	LV009806_00	CONVOGLIATORE 5T-R290	1
12	A50500067	PIEDINO DIAM.67 (ASS.2") BASE 13 H86	4
13	PP11065M	Bacinella gn1/1 h65	1
14	A50400011	REGGIGRIGLIA 5 TEGLIE CON SPILLONE	1
15	A50400012	REGGIGRIGLIA 5 TEGLIE	1
16	TB630	GUARNIZIONE MAGNETICA	1
17	LV009763_00	CERNIERA SUPERIORE PIVOT	1
18	A50500081		1
19	LV009767_00	ASSIEME CRUSCOTTO 5T DIGIT	1
20	A50400013	GRIGLIA GN 1/1	1
21	TB854	GRIGLIA X VENT.A2E250 ART.106FG0117	1
22	TB853	VENTIL. A2E250-AM06-12 + CONDENS.	1
23	0061A95930100	ASSIEME PORTA SCHIUMATA 5T PROFI LINE	1

	<b>DIAMOND EUROPE</b> SA/NV	FINITURA/Finish SB		PESO/Weight (kg)
	Chaussée de Vilvorde 92 Brussels - Belgium	RIFERIMENTO / Reference GTP-5/2R	CODICE CLIENTE 7190	SCALA/Scale 1:12
DENOMINAZIONE/Name <b>BLAST CHILLER 5T DIGIT R290</b>		GREZZO/Stock size mm	ORIENTAMENTO	
Il presente disegno è proprietà della Diamond Non può essere copiato o mostrato a terzi senza preventiva autorizzazione scritta. La Società tutelerà a termini di legge. This drawing is property of Diamond and may not be reproduced nor disclosed to third parties without the written consent of Diamond Any abuse will be prosecuted.		FIRMA/Sign MG		REV/Rev 00