



MOD : GTP-3/1R

Production code : LF03DD-GN11R

01/2026

PIEGHE IN GIU'

 PIEGHE IN SU'

This drawing contains confidential information and is the property of DIAMOND, without whose permission it may not be copied, shown or handed to a third party or otherwise used, and it is to be returned promptly upon request to the DIAMOND, which is responsible for the drawing. SUPPLY SPECIFICATIONS / SPECIFICHE DI FORNITURA. Remove all punching burrs after machining or press-forming process. draft angle 2°. fillets not quoted R=2, internal bend radius as thickness. chamfers not quoted: 0.5x45°. For other specifications please contact the technical department.

	0.4	—	0.2/100
	0.4	//	0.2/100
	0.25	⊥	0.2/100

Angles ± 1°
 Angoli ± 1°

General tolerance - Tolleranza generale: UNI EN 227 68/1 - C	
Length and diam. Lungh. e diametri	> 4000 2000 1000 315 120 30.0 6.00
Tolerance Tolleranza	± 0.2 ± 0.5 ± 0.8 ± 1.2 ± 2.0 ± 3.0 ± 4.0 ± 5.0

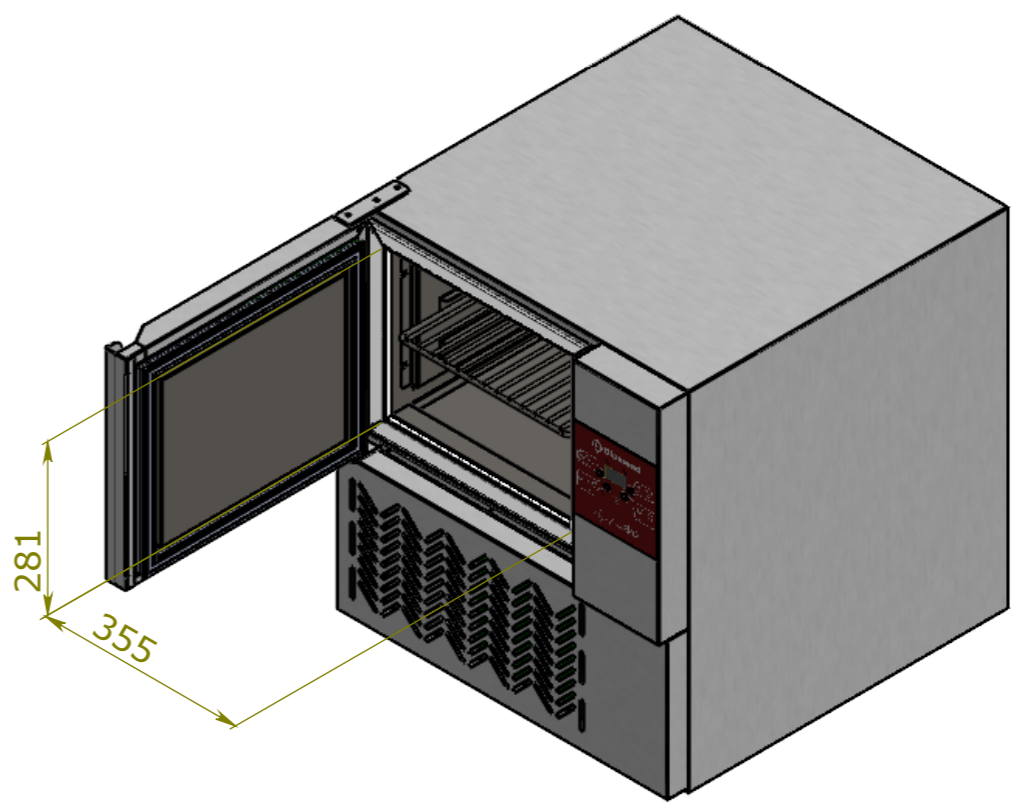
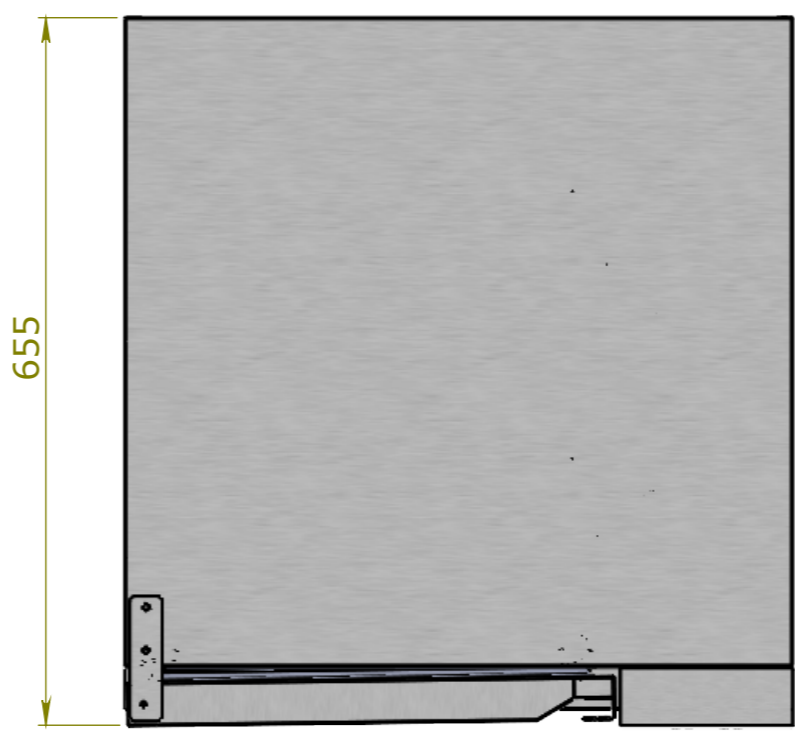
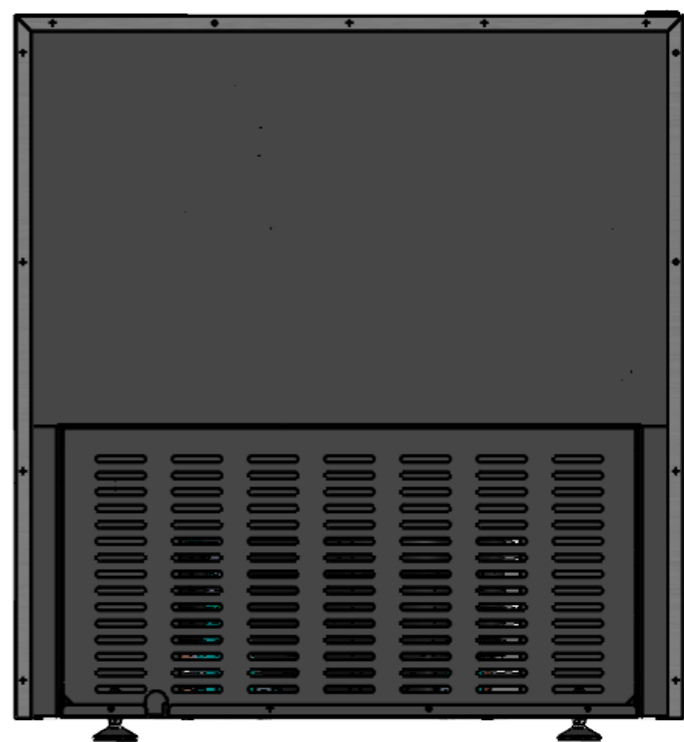
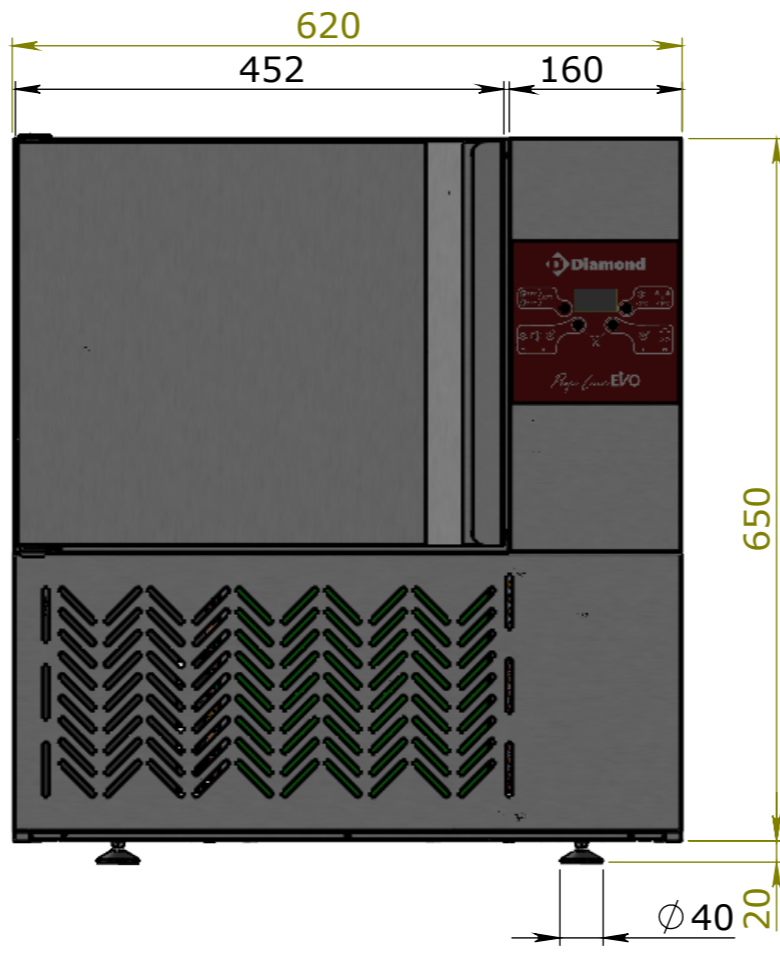
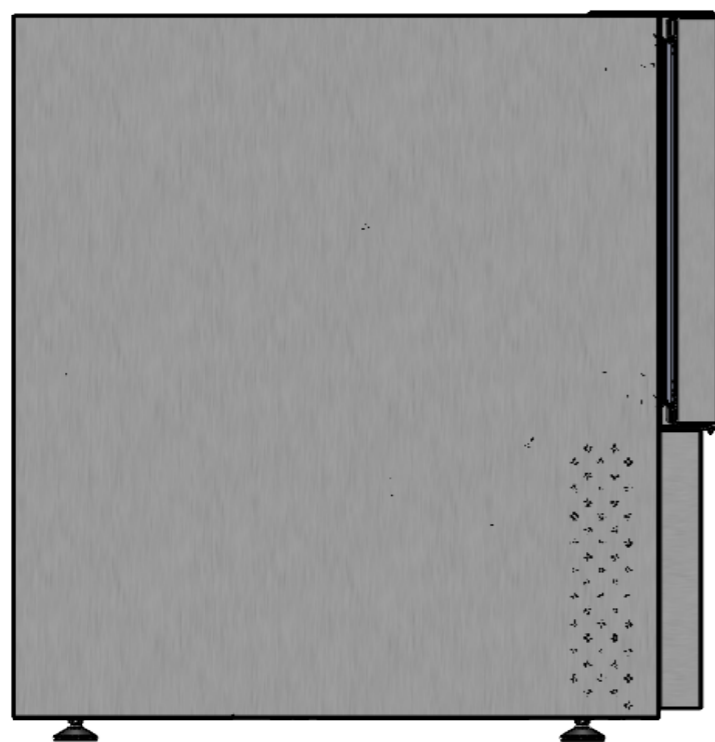

 Chaussée de Vilvorde 92 Brussels - Belgium DENOMINAZIONE/Name BLAST CHILLER 3T GN1/1 R290 DIG.	RIFERIMENTO / Reference GTP-3/1R	FINITURA/Finish SB	 PESO/Weight (kg)
		DIAMOND EUROPE SA/NV	SCALA/Scale 1:10 DATA/Date 11/10/25
GREZZO/Stock size mm		ORIENTAMENTO 	FIRMA/Sign GB
Il presente disegno è proprietà della Diamond Non può essere copiato o mostrato a terzi senza preventiva autorizzazione scritta. La Società tutelerà a termini di legge. This drawing is property of Diamond and may not be reproduced nor disclosed to third parties without the written consent of Diamond Any abuse will be prosecuted.			REV/Rev 00

This drawing contains confidential information and is the property of DIAMOND, without whose permission it may not be copied, shown or handed to a third party or otherwise used, and it is to be returned promptly upon request to the DIAMOND, which is responsible for the drawing. SUPPLY SPECIFICATIONS / SPECIFICHE DI FORNITURA
Remove all punching burrs after machining or press-forming process. draft angle 2°
fillets not quoted R=2, internal bend radius as thickness. chamfers not quoted: 0.5x45°
For other specifications please contact the technical Department.

	0.4	—	0.2/100
	0.4	//	0.2/100
	0.25	⊥	0.2/100

Angles ± 1°
Angoli ± 1°

General tolerance - Tolleranza generale: UNI EN 227 68/1 - C	
Length and diam. Lungh. e diametri	> 4000 2000 1000 315 120 30.0 6.00
Tolerance Tolleranza	± 0.2 ± 0.5 ± 0.8 ± 1.2 ± 2.0 ± 3.0 ± 4.0 ± 5.0

PIEGHE IN GIU'
PIEGHE IN SU'

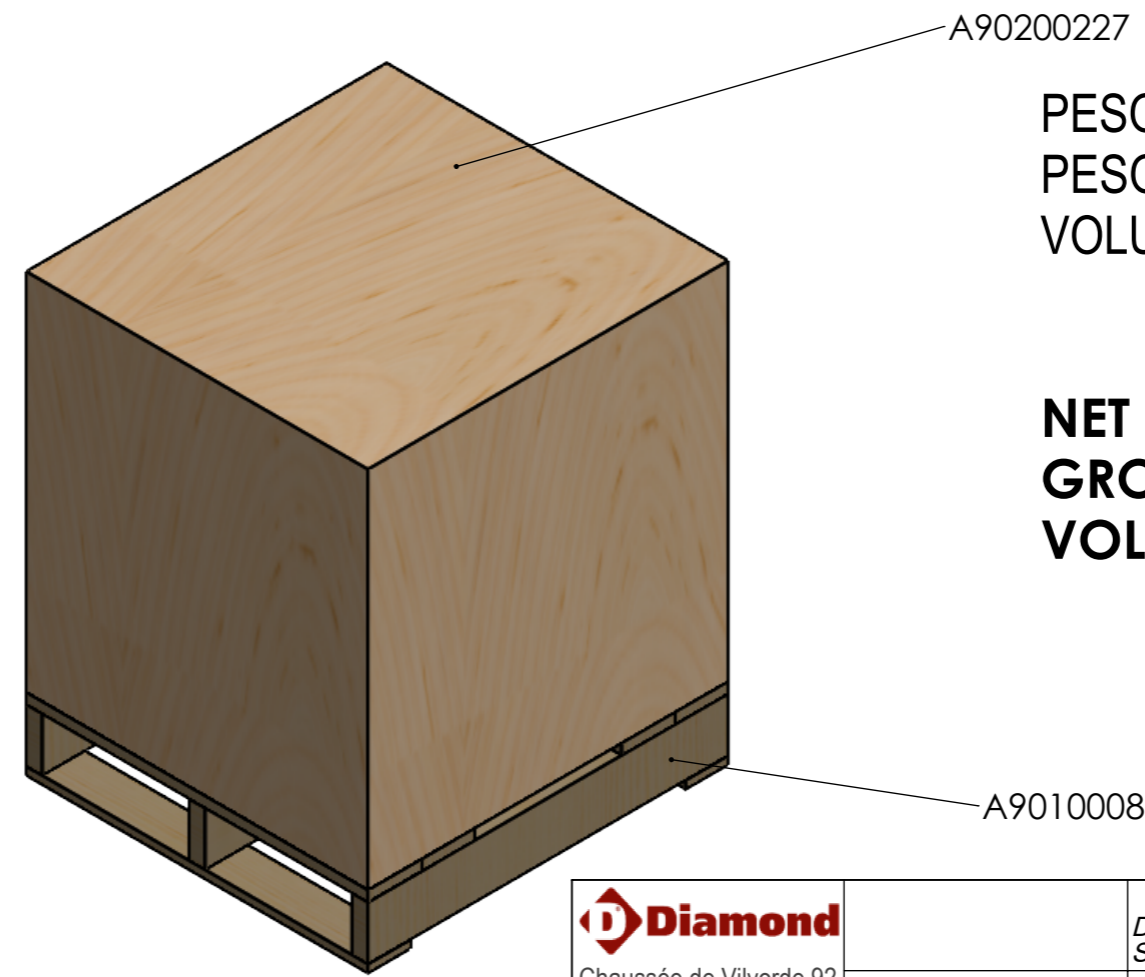
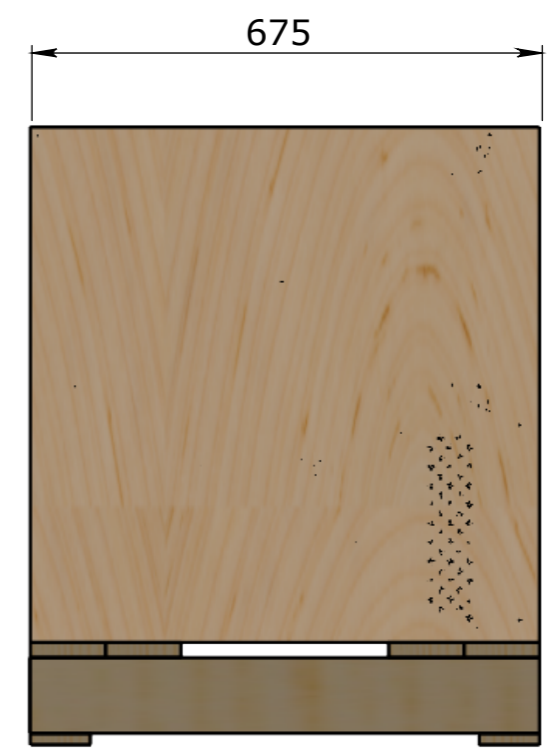
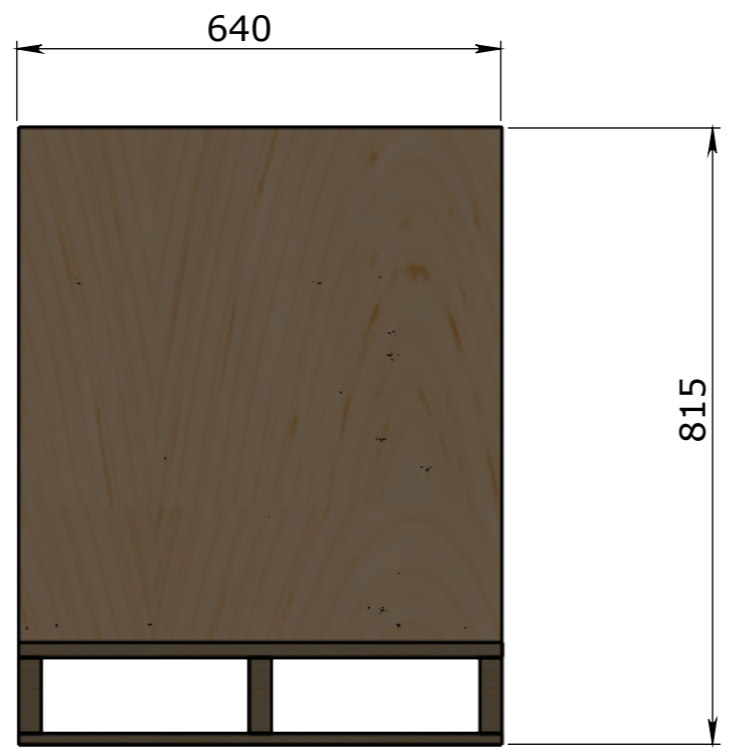

PESO NETTO 48,00KG
PESO LORDO 75,00KG
VOLUME 0.35MC

NET WEIGHT 48.00KG
GROSS WEIGHT 75.00KG
VOLUME 0.35MC

 Chaussée de Vilvorde 92 Brussels - Belgium DENOMINAZIONE/Name BLAST CHILLER 3T GN1/1 R290 DIG.	RIFERIMENTO / Reference GTP-3/1R	DIAMOND EUROPE SA/NV	FINITURA/Finish SB	 PESO/Weight (kg)
			GREZZO/Stock size <i>mm</i>	SCALA/Scale 1:10 DATA/Date 11/10/25
Il presente disegno è proprietà della Diamond Non può essere copiato o mostrato a terzi senza preventiva autorizzazione scritta. La Società tutelerà a termini di legge. This drawing is property of Diamond. an may not be reproduced nor disclosed to third parties without the written consent of Diamond Any abuse will be prosecuted.			ORIENTAMENTO 	FIRMA/Sign GB
			REV/Rev 00	SHEET 2 OF 3

PIEGHE IN GIU'
PIEGHE IN SU'

This drawing contains confidential information and is the property of DIAMOND, without whose permission it may not be copied, show, DIAMOND, which is responsible for the drawing, SUPPLY SPECIFICATIONS / SPECIFICHE DI FORNITURA. Remove all punching burrs after machining or press-forming process, draft angle 2°. Fillets not quoted R=2; internal bend radius as thickness; chamfers not quoted: 0,5x45°. For other specifications please contact the Technical Department.

—	0.2/100
∥	0.2/100
○	0.4
◎	0.25

Angles ± 1°
Angoli ± 1°

General tolerance - Tolleranza generale: UNI EN 227 68/1 - C	
Length and diam. Lungh. e diametri	> 4000 2000 1000 315 120 30.0
Tolerance Tolleranza	± 0.2 ± 0.5 ± 0.8 ± 1.2 ± 2.0 ± 3.0 ± 4.0 ± 5.0

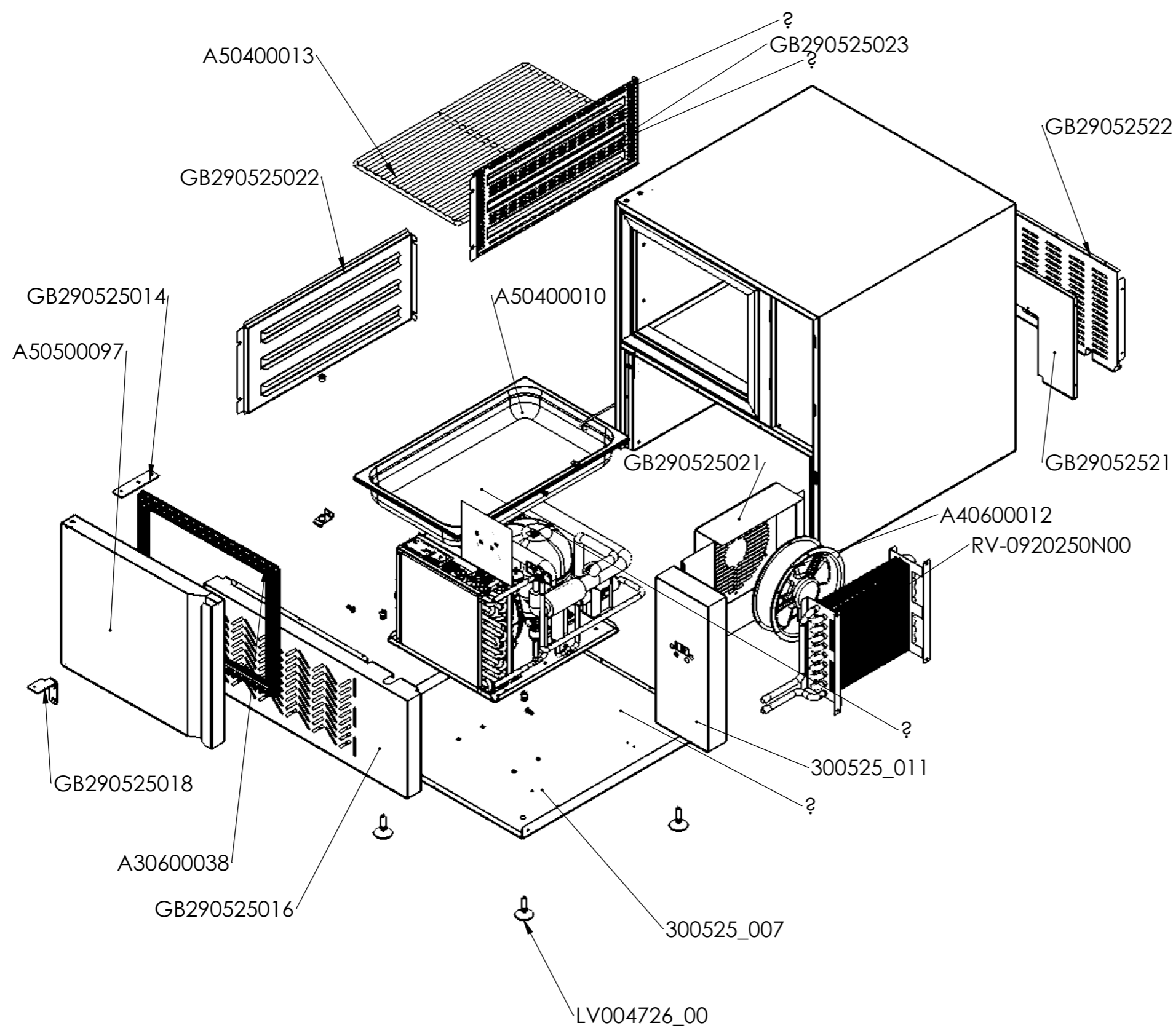

Tabella Distinta materiali			
Num. articolo	Codice	Descrizione	QUANTITA'
1	A50500096	ASM. CASSONE SCHIUMATO 3T GN1/1	1
2	A50500097	ASS PORTA SCHIUMATA	1
3	A30600038	GUARNIZIONE MAGNETICA 3T GN1/1	1
4	GB290525014	STAFFA CERNIERA SUPERIORE	1
5	300525_007	BASAMENTO GRUPPO	1
6	GB290525016	PANNELLO CONDENSATORE	1
7	GB290525018	STAFFA INFERIORE CERNIERA	1
8	TB631	BOCCOLA ROTAZIONE PORTA	2
9	TB790	PERNO ROTAZIONE PORTE	2
11	RV-0920250N00	EVAPORATORE 18T 9T-2R-250-PA-5	1
12	LV004726_00	PIEDINO SNODATO M8 D40 H76	4
13	CS-43052S	Filtro Antiacido a Saldare 80x1/4"	1
14	DF-068Z3427	VALVOLA TERMOSTATICA TS2 R404A MOP30 ODS	1
16	GB29052521	CHIUSURA CONDENSATORE	1
18	GB29052522	GRIGLIA POSTERIORE	1
19	300525_011	CRUSCOTTO COMANDI 4.4	1
20	GB290525021	CONVOGLIATORE CELLA	1
21	A40600012	VENTILATORE 220X60 230VAC 50/60Hz BALL BEARING - WIRE	1
24	GB290525022	SUPPORTO TEGLIA SX	1
25	A50400010	BACINELLA 1/1 GN H65	1
26	A50400013	GRIGLIA GN 1/1	1
27	GB290525023	SUPPORTO TEGLIE DX/sx	1
30	A40400001	SCHEDA COMADI BLAST ATEX	1
31	A40400004	MOSTRINA DIGIT	1
32	2299-2990	GRUPPO 3 TEGLIE R290	1

	DIAMOND EUROPE SA/NV	FINITURA/Finish SB	PESO/Weight (kg)
	Chaussée de Vilvorde 92 Brussels - Belgium DENOMINAZIONE/Name BLAST CHILLER 3T GN1/1 R290 DIG.	RIFERIMENTO / Reference GTP-3/1R	GREZZO/Stock size mm
Il presente disegno è proprietà della Diamond Non può essere copiato o mostrato a terzi senza preventiva autorizzazione scritta. La Società tutelera i termini di legge. This drawing is property of Diamond and may not be reproduced nor disclosed to third parties without the written consent of Diamond Any abuse will be prosecuted.		ORIENTAMENTO 	FIRMA/Sign GB REV/Rev 00