



MOD : CBT31/R2

Production code : LF03TE-GN11TR

Jet engine compressor drawings

Creative
MARKET

11/2025

PIEGHE IN GIU'

 PIEGHE IN SU'

This drawing contains confidential information and is the property of DIAMOND, without whose permission it may not be copied, shown or handed to a third party or otherwise used, and it is to be returned promptly upon request to the DIAMOND, which is responsible for the drawing. SUPPLY SPECIFICATIONS / SPECIFICHE DI FORNITURA
 Remove all punching burrs after machining or press-forming process. draft angle 2°
 fillets not quoted R=2, internal bend radius as thickness, chamfers not quoted: 0.5x45°.
 For other specifications please contact the technical department.

—	0.2/100
//	0.2/100
□	0.4
○	0.4
◎	0.25

Angles ± 1°
 Angoli ± 1°

General tolerance - Tolleranza generale: UNI EN 227 68/1 - C	
Length and diam. Lungh. e diametri	>
0,00 6,00 30,0 120 315 1000 2000 4000	31,5 1000 2000 4000
6,00 30,0 120 315 1000 2000 4000	4000
Tolerance Tolleranza	± 0,2 ± 0,5 ± 0,8 ± 1,2 ± 2,0 ± 3,0 ± 4,0 ± 5,0

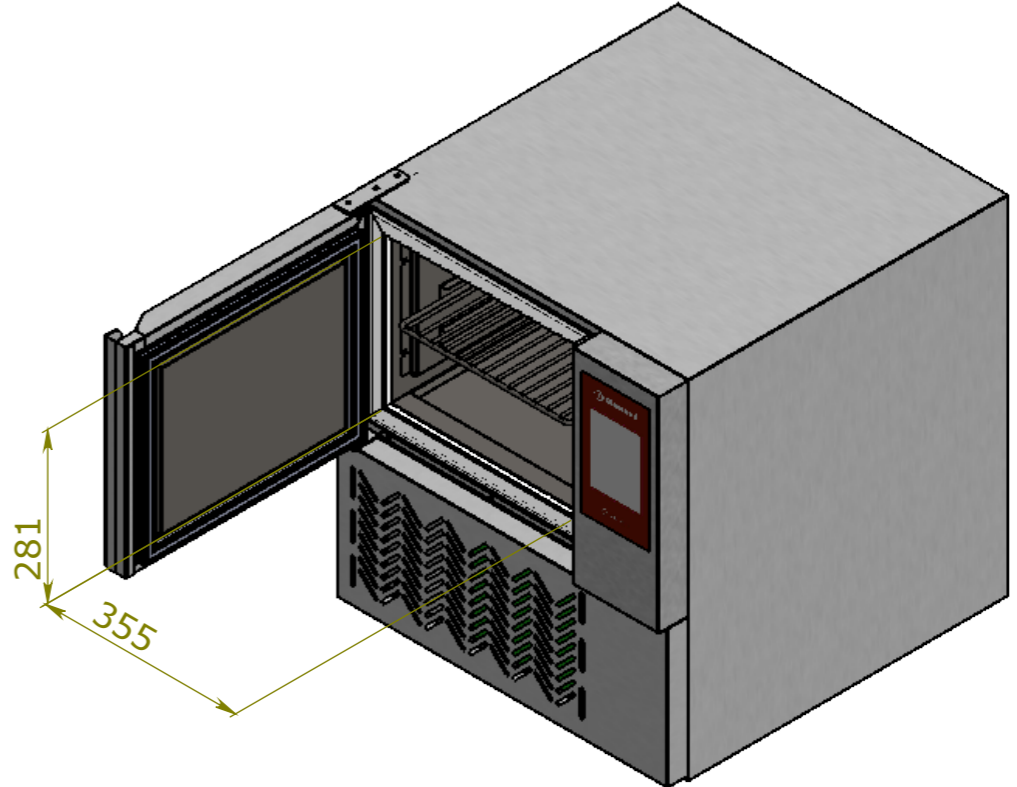
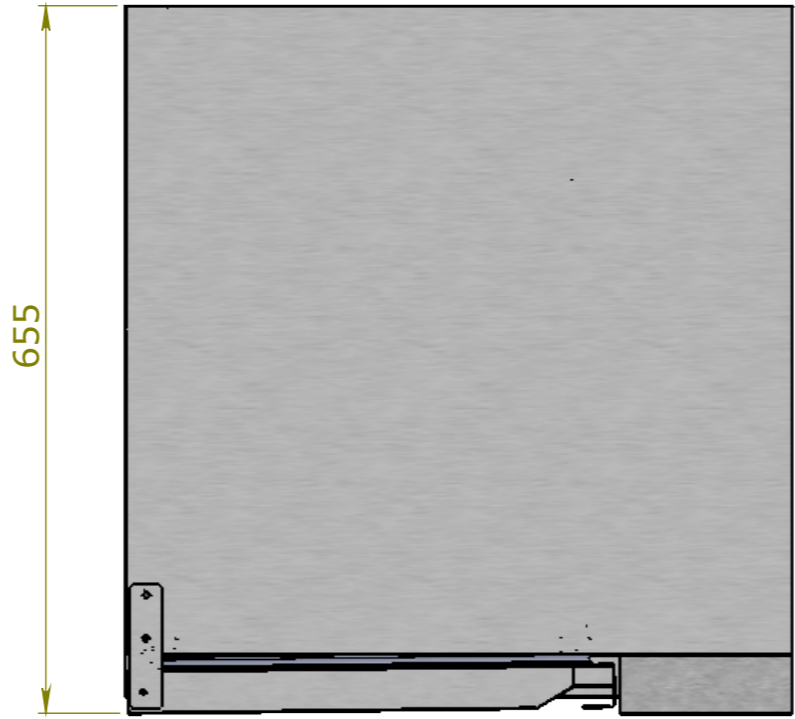
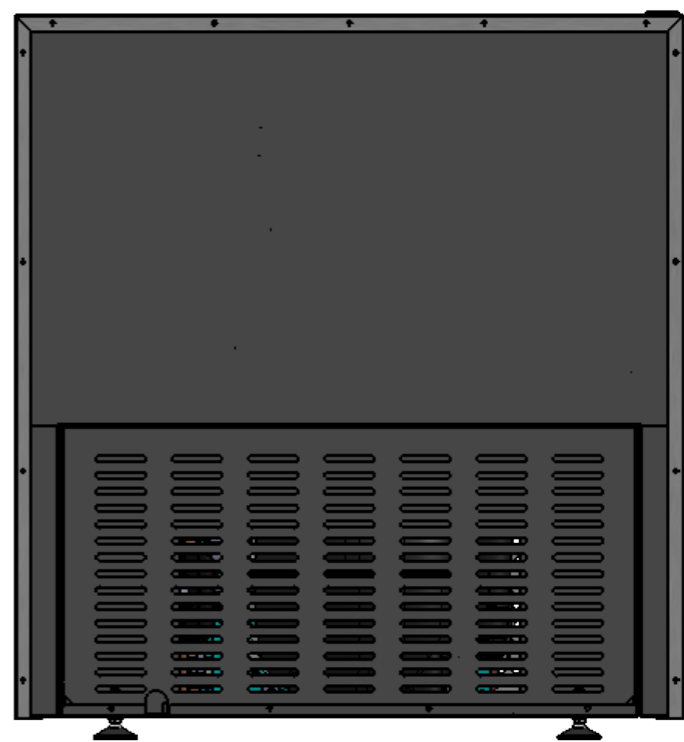
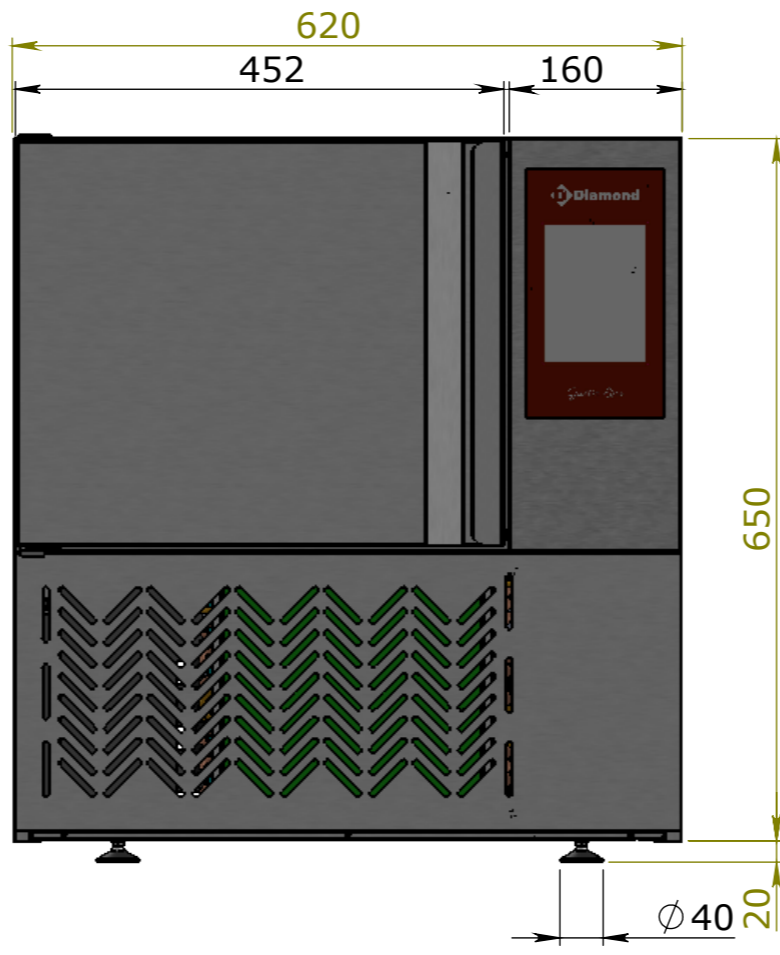
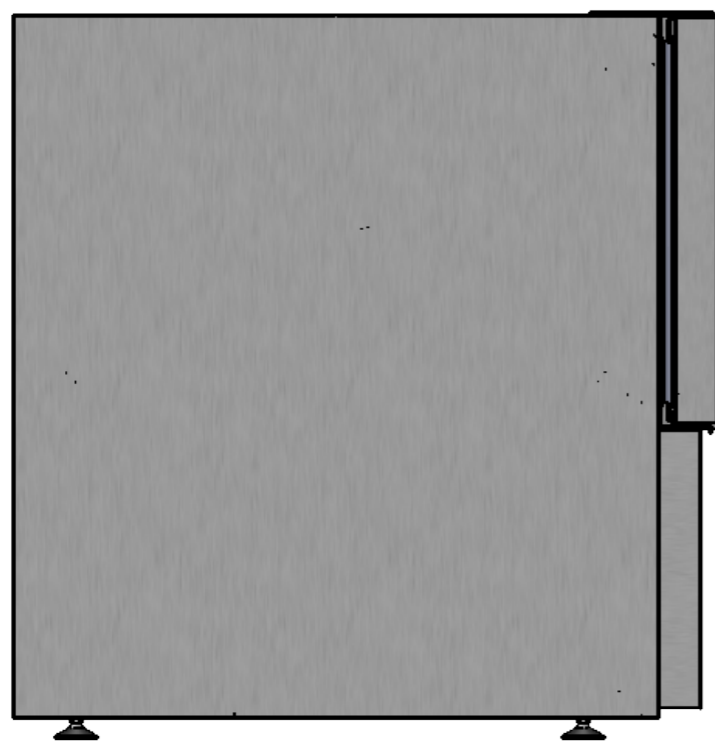

Modello / model	CBT31/R2	
dimensioni	LxPxH mm	620x655h670
larghezza luce porta	mm	680
altezza luce porta	mm	380
profondità interna	mm	415
SPESSORE COIBENTAZIONE	mm	60
classe climatica		4
capacità abbattimento	kg	18
capacità congelamento	kg	12
refrigerante	gas	R290
capacità refrigerazione 1)	W	1416
alimentazione elettrica	V/Hz	230/1/50
potenza elettrica	W	815
corrente max	A	4,6
allestimento catering		3 GN 1/1
passo teglie	mm	75
peso netto	kg	75
cavo elettrico	mm ²	3x1,5
tubo scarico acqua	Ø	1/2"

Diamond Chaussée de Vilvorde 92 Brussels - Belgium DENOMINAZIONE/Name BLAST CHILLET 3T GN1/1 TOUCH R290	DIAMOND EUROPE SA/NV RIFERIMENTO / Reference CBT31/R2	FINITURA/Finish 	PESO/Weight (kg)
		MATERIALE/Material 	SCALA/Scale 1:10 DATA/Date 27/10/25
GREZZO/Stock size mm		ORIENTAMENTO 	FIRMA/Sign GB
SIMMETRICO/Simmetrical code 		REV/Rev 00	

Il presente disegno è proprietà della diamond Non può essere copiato o mostrato a terzi senza preventiva autorizzazione scritta. La Società tutelera i termini di legge.
 This drawing is property of Diamond and may not be reproduced nor disclosed to third parties without the written consent of Diamond. Any abuse will be prosecuted.

This drawing contains confidential information and is the property of DIAMOND, without whose permission it may not be copied, shown or handed to a third party or otherwise used, and it is to be returned promptly upon request to the DIAMOND, which is responsible for the drawing. SUPPLY SPECIFICATIONS / SPECIFICHE DI FORNITURA
Remove all punching burrs after machining or press-forming process. draft angle 2°
fillets not quoted R=2, internal bend radius as thickness. chamfers not quoted: 0.5x45°
For other specifications please contact the technical department.

	0.4	—	0.2/100
	0.4	//	0.2/100
	0.25	⊥	0.2/100

Angles ± 1°
Angoli ± 1°

General tolerance - Tolleranza generale: UNI EN 227 68/1 - C	
Length and diam. Lungh. e diametri	>
0.00 6.00 30.0 120 315 1000 2000 4000	315 1000 2000 4000
6.00 30.0 120 315 1000 2000 4000	4000
Tolerance Tolleranza	± 0.2 ± 0.5 ± 0.8 ± 1.2 ± 2.0 ± 3.0 ± 4.0 ± 5.0

PIEGHE IN GIU'
PIEGHE IN SU'

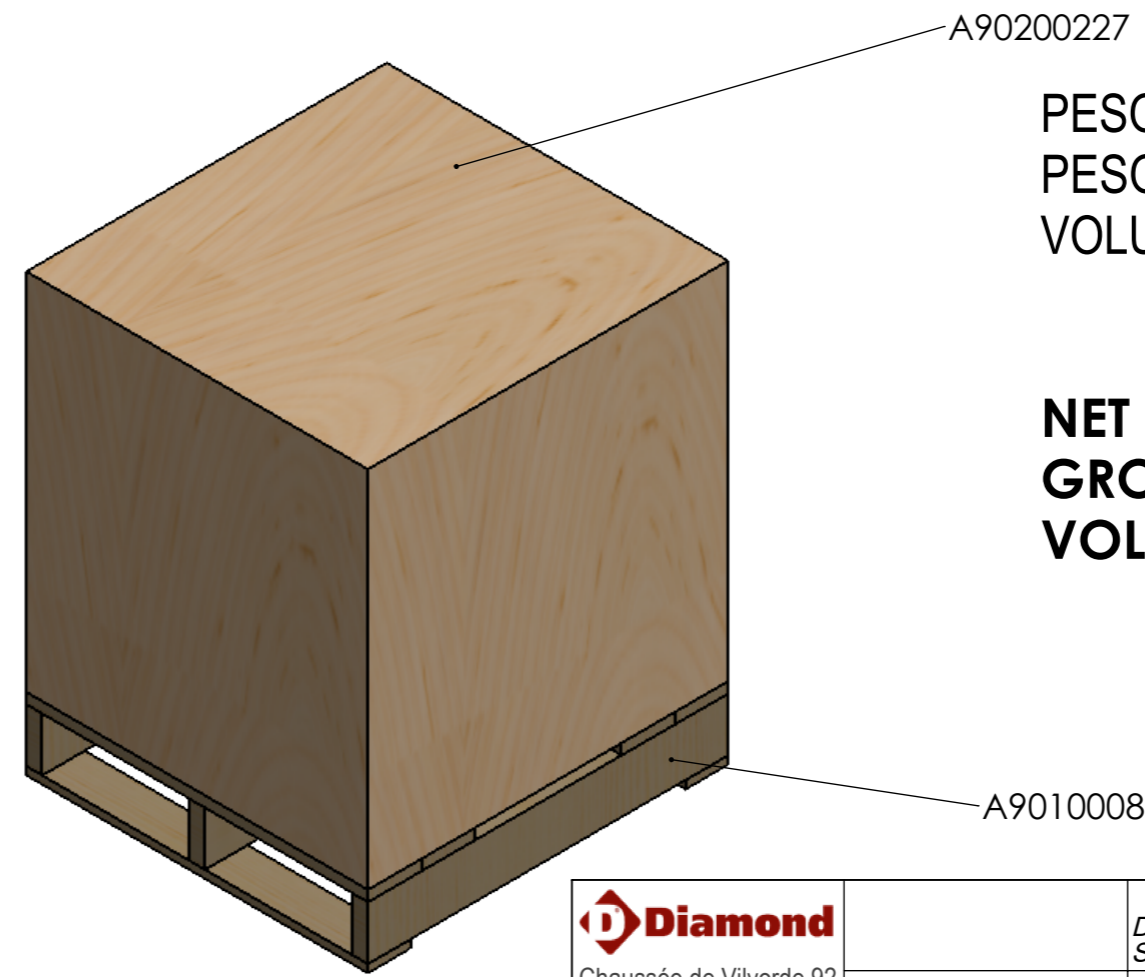
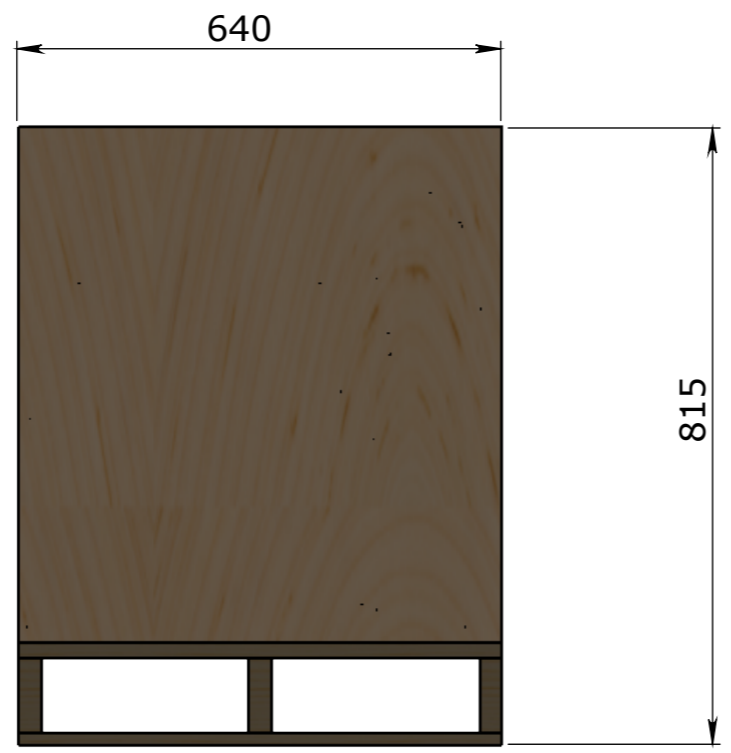

PESO NETTO 48,00KG
PESO LORDO 75,00KG
VOLUME 0.35MC

NET WEIGHT 48.00KG
GROSS WEIGHT 75.00KG
VOLUME 0.35MC

 Chaussée de Vilvorde 92 Brussels - Belgium DENOMINAZIONE/Name BLAST CHILLET 3T GN1/1 TOUCH R290	RIFERIMENTO / Reference CBT31/R2	FINITURA/Finish DIAMOND EUROPE SA/NV	 PESO/Weight (kg)
		MATERIALE/Material GREZZO/Stock size <i>mm</i>	SCALA/Scale 1:10 DATA/Date 27/10/25
SIMMETRICO/Simmetrical code BLAST CHILLET 3T GN1/1 TOUCH R290		ORIENTAMENTO 	FIRMA/Sign GB REV/Rev 00

Il presente disegno è proprietà della Diamond Non può essere copiato o mostrato a terzi senza preventiva autorizzazione scritta. La Società tutelerà a termini di legge.
This drawing is property of Diamond and may not be reproduced nor disclosed to third parties without the written consent of Diamond. Any abuse will be prosecuted.

PIEGHE IN GIU'
PIEGHE IN SU'

This drawing contains confidential information and is the property of DIAMOND, without whose permission it may not be copied, shown or handed to a third party or otherwise used, and it is to be returned promptly upon request to the DIAMOND, which is responsible for the drawing. SUPPLY SPECIFICATIONS / SPECIFICHE DI FORNITURA
Remove all punching burrs after machining or press-forming process. draft angle 2°
fillets not quoted R=2, internal bend radius as thickness, chamfers not quoted: 0.5x45°.
For other specifications please contact the technical department.

	0.2/100
	0.4
	0.4
	0.25

Angles ± 1°
Angoli ± 1°

General tolerance - Tolleranza generale: UNI EN 227 68/1 - C	
Length and diam. Lung. e diametri	> 4000 2000 1000 315 120 30.0 6.00
Tolerance Tolleranza	± 0.2 ± 0.5 ± 0.8 ± 1.2 ± 2.0 ± 3.0 ± 4.0 ± 5.0

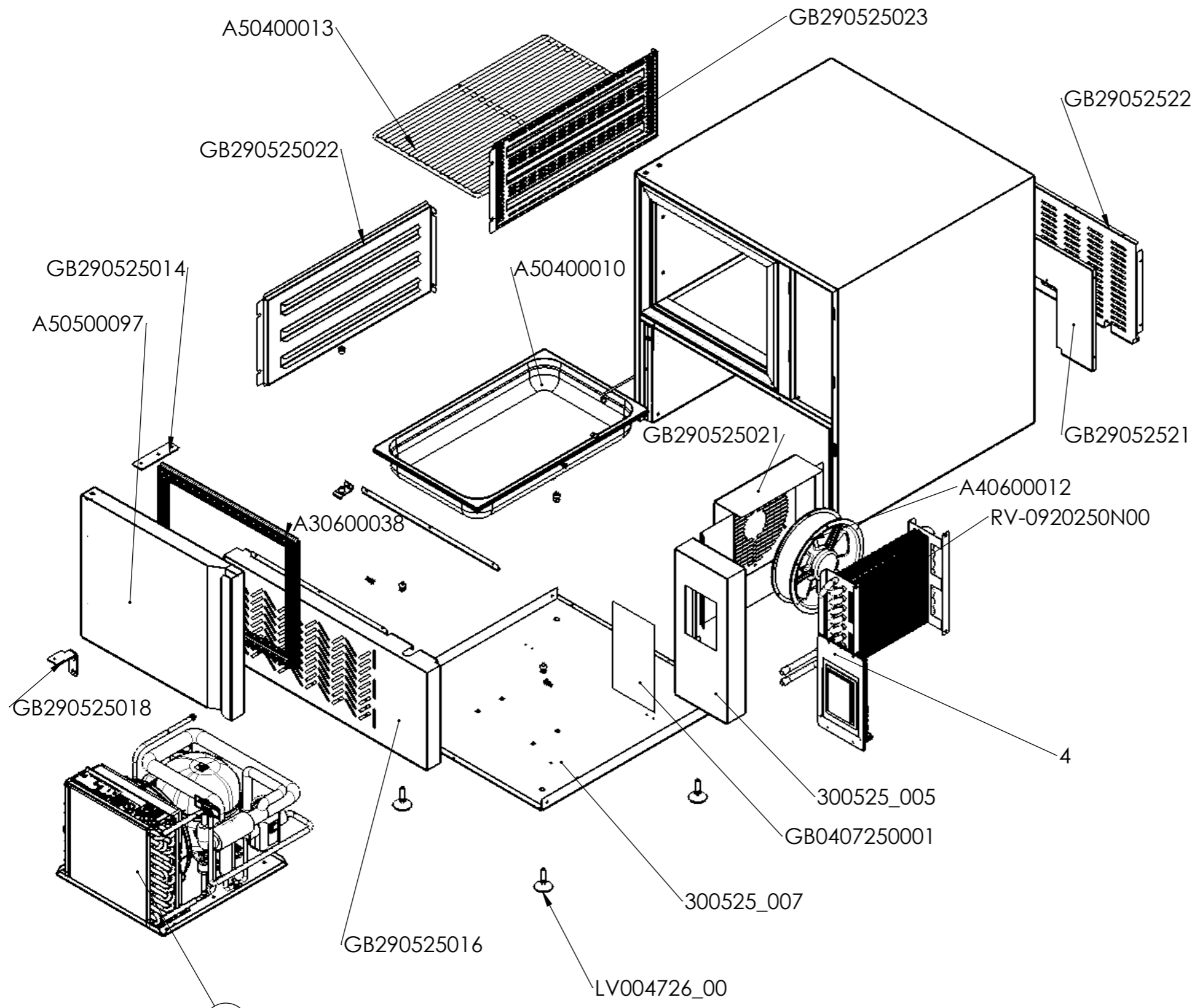

Tabella Distinta materiali			
Num. articolo	Codice	Descrizione	QUANTITA'
1	A50500096	ASM. CASSONE SCHIUMATO 3T GN1/1	1
2	A50500097	ASS PORTA SCHIUMATA	1
3	A30600038	GUARNIZIONE MAGNETICA 3T GN1/1	1
4	300525_003	ASSIEME SCHEDA	1
5	GB290525014	STAFFA CERNIERA SUPERIORE	1
6	300525_007	BASAMENTO GRUPPO	1
7	GB290525016	PANNELLO CONDENSATORE	1
8	GB290525018	STAFFA INFERIORE CERNIERA	1
9	TB631	BOCCOLA ROTAZIONE PORTA	2
10	TB790	PERNO ROTAZIONE PORTE	2
12	RV-0920250N00	EVAPORATORE 18T 9T-2R-250-PA-5	1
13	LV004726_00	PIEDINO SNODATO M8 D40 H76	4
14	GB29052521	CHIUSURA CONDENSATORE	1
16	GB29052522	GRIGLIA POSTERIORE	1
17	300525_005	CRUSCOTTO COMANDI 4.4	1
18	GB290525021	CONVOGLIATORE CELLA	1
19	A40600012	VENTILATORE 220X60 230VAC 50/60Hz BALL BEARING - WIRE	1
22	GB290525022	SUPPORTO TEGLIA SX	1
23	A50400010	BACINELLA 1/1 GN H65	1
24	A50400013	GRIGLIA GN 1/1	1
25	GB290525023	SUPPORTO TEGLIE DX	1
26	GB0407250001	MOSTRINA ADESIVA	1
29	GB290525033	STAFFA FISSAGGIO	1
30	2299-2990	GRUPPO 3 TEGLIE R290	1

	DIAMOND EUROPE SA/NV	FINITURA/Finish		PESO/Weight (kg)
		MATERIALE/Material	SCALA/Scale	DATA/Date
Chaussée de Vilvorde 92 Brussels - Belgium DENOMINAZIONE/Name BLAST CHILLET 3T GN1/1 TOUCH R290	RIFERIMENTO / Reference CBT31/R2	GREZZO/Stock size mm	ORIENTAMENTO 	1:10 27/10/25
Il presente disegno è proprietà della Diamond Non può essere copiato o mostrato a terzi senza preventiva autorizzazione scritta. La Società tutelerà a termini di legge. This drawing is property of Diamond and may not be reproduced nor disclosed to third parties without the written consent of Diamond. Any abuse will be prosecuted.		SIMMETRICO/Simmetrical code	FIRMA/Sign GB	REV/Rev 00