

high pressure compressor

low pressure compressor

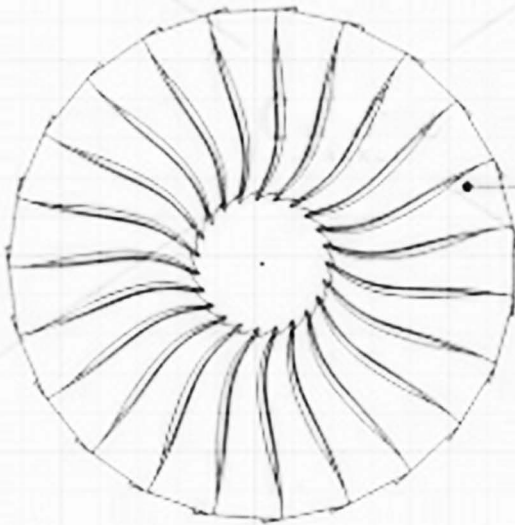

fan

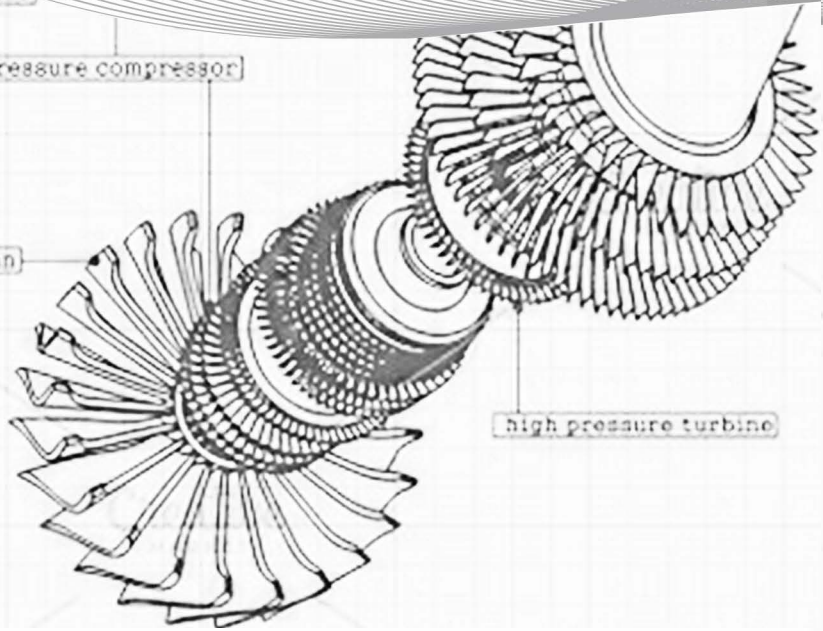

high pressure turbine

MOD : WR-P501-L2

Production code : 65208022HL_

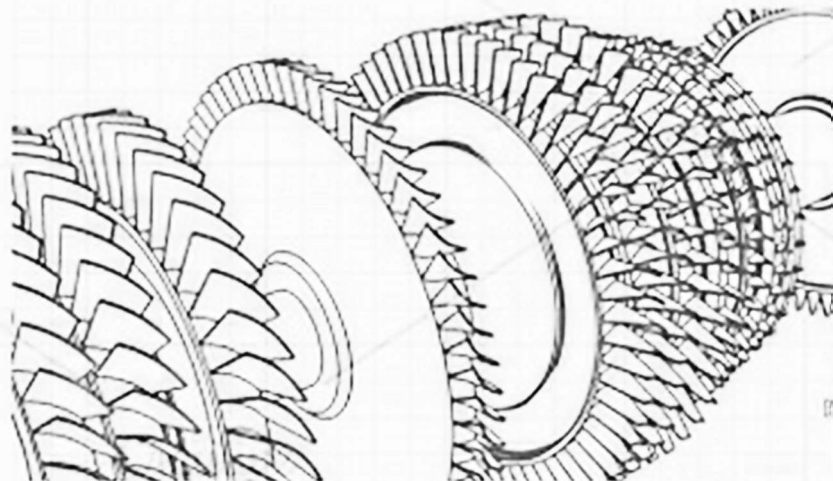
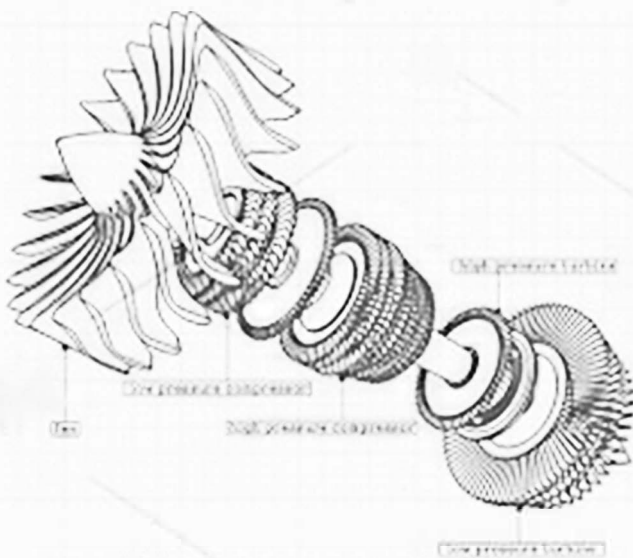

low pressure turbine

low pressure compressor

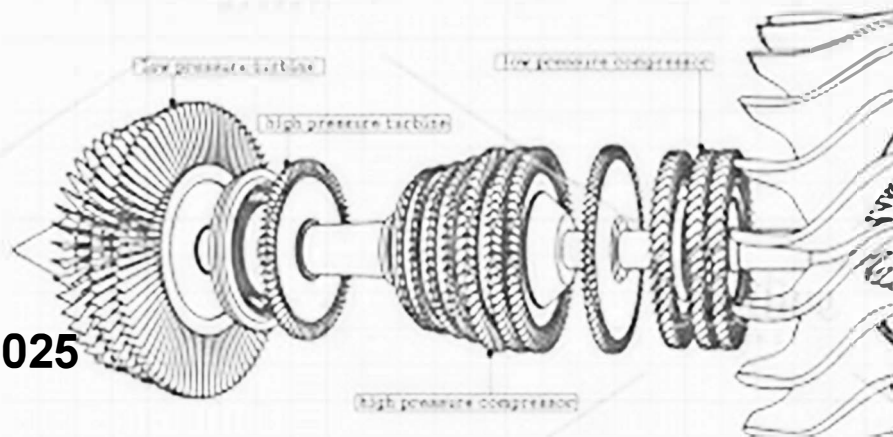
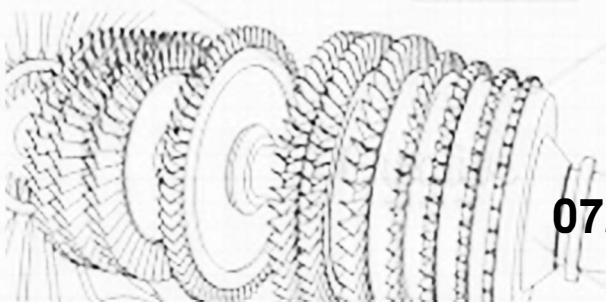

high pressure compressor

07/2025

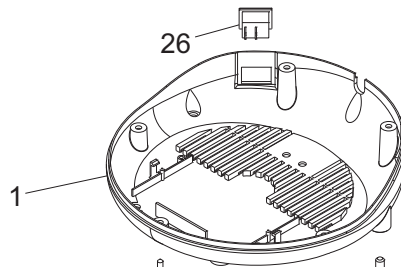
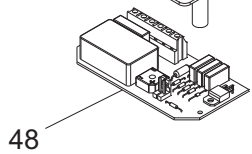
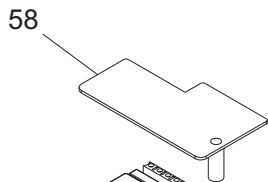
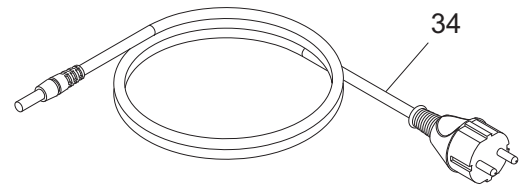
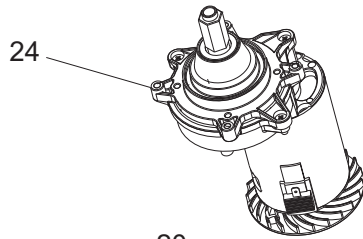
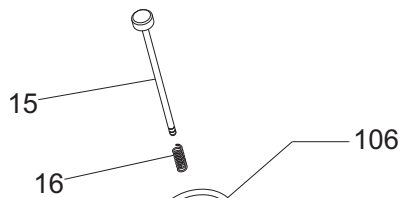
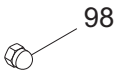
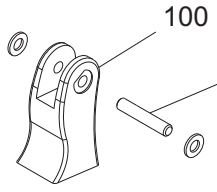
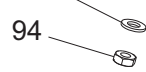
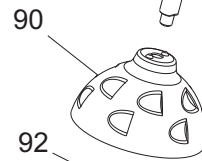
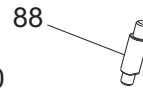
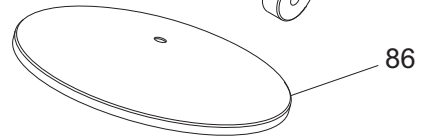
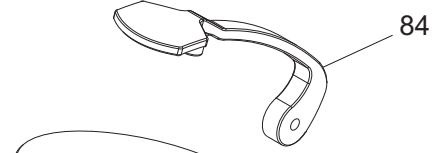
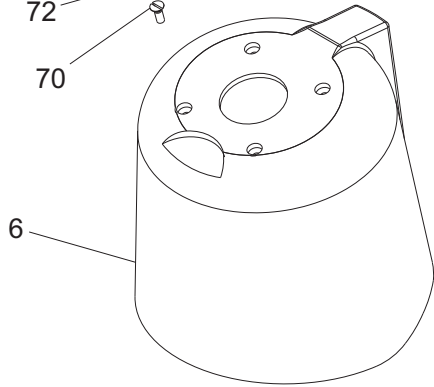
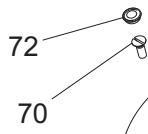
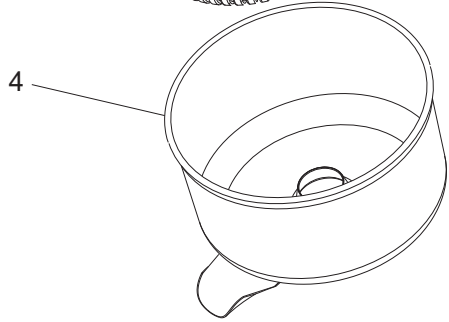
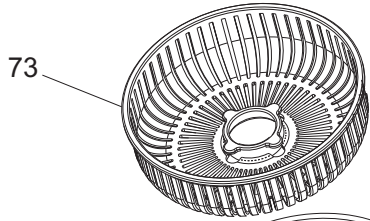
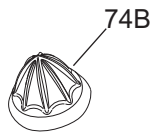
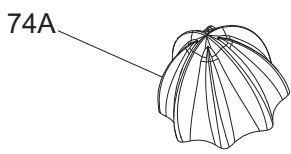

WR-P501-L2

Réf.	Nom produit	Code	Q
1	BLACK BOTTOM COVER _ APOLLO/DRAGONE	IB4000710	1
4	JUICE CONTAINER MRC	IB1000002	1
6	CAMPANA NERA Y15 PLL	IB4070700.15	1
15	ASTINA MICRO	IB2080733	1
16	MICROSWITCH SPRING _ APOLLO	IB76M0701	10
20	ANELLO ZA 4 ARRESTO APO/MRC	IB77AN04	10
24	MOTOR 62 4 071.1 220V CC	IB5080705	1
26	ON/OFF SWITCH _ FRE/PLL	IB5800100	1
34	SHUKO CABLE	IB5504003	1
42	VITE AUT.TC CROCE ZIN. 3,5X13	IB76VCR03.5X13	10
46	RUBBER FOOT APL	IB4306402	10
48	PC BOARD RESIN-COATED	IB5940702	1
58	COVER PLATE	IB4000715	1
70	INOX SCREW M5x14	IB77VSC05X14	10
72	RUBBER CUP	IB4180710	10
73	SIEVE, MRC	IB4000750	1
74A	SQUEEZING CONE BIG, MRC	IB4000730	1
74B	SQUEEZING CONE SMALL, MRC	IB4000735	1
84	S/S LEVER COVER SA	IB1280705	1
86	LEVER LID _ APOLLO LEVER	IB2260715	1
88	S/S SPACER FOR SQUEEZER APOLLO	IB2080716	1
90	S/STEEL CUP _ APOLLO/MERCURIO	IB1000005	1
92	S/STEEL WASHER D.08X15	IB77R08X15	20
94	S/S NUT M 8 _ APOLLO	IB77D08MS	10
96	STUD BOLT, GALVANIZED _ APOLLO	IB2020700	1
98	S/S BLIND NUT M 8 _ APOLLO	IB77DC08	5
100	ANODIZED LEVER SUPPORT _ APOLLO	IB1280710	1
102	CSK HEX.SCREW M 6 X 16	IB76VEI06X16	10
104	WASHER GROWER D.6	IB76RG06	1
106	OR 4175 _ AP	IB4104034	10