



**MOD : PPL-800VS**

**Production code : 908601/DIAMOND**

**06/2025**

**INSTALLATION – USE – MAINTENANCE**  
**DIVIDER**  
**MOD. PPL-800VS**

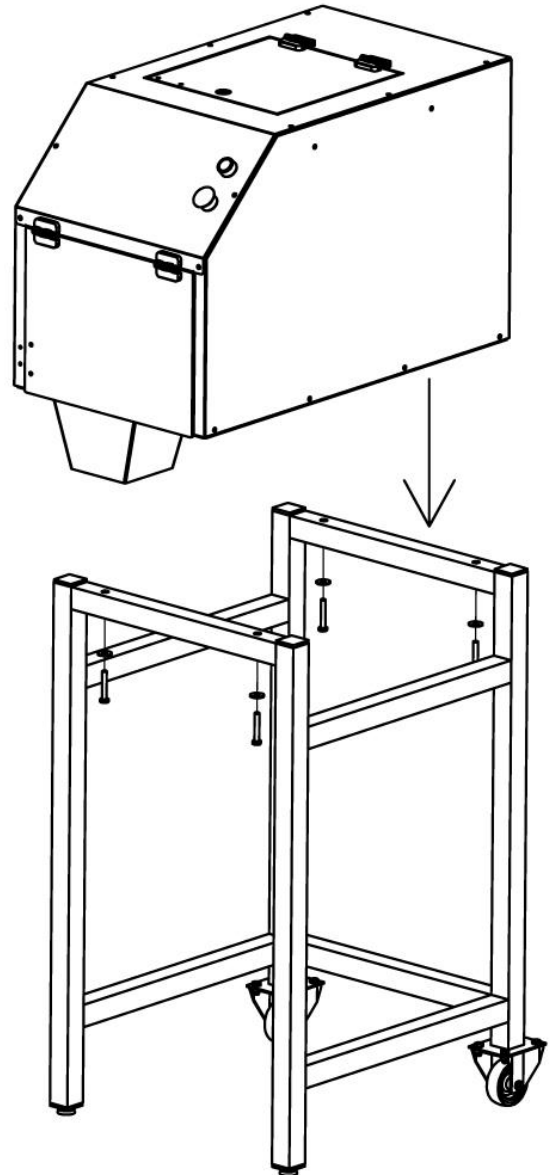

## **INDEX**

	PAGE
<b>1. INFORMATION ON SAFETIES</b>	
1.1 GENERAL PRECAUTIONS	11
1.2 MECHANICAL SAFETIES	11
1.3 ELECTRICAL SAFETIES	11
<b>2. TECHNICAL FEATURES</b>	
2.1 TABLE OF WEIGHTS AND MEASURES - NOISE	12
2.2 SUPPLY CONDITIONS AND DISPOSAL OF PACKINGS	12
<b>3. INSTALLATION</b>	
3.1 SETTING THE MACHINE	12
3.2 ELECTRIC CONNECTIONS	13
3.3 SAFETY MEASURES AND TRAINING THE FINAL USER	13
<b>4. USE OF THE EQUIPMENT</b>	
4.1 CONTROLS	13
4.2 REGULATION OF THE PORTION WEIGHT	13
4.3 CHANGE THE EXTRUSION CONE	13
4.4 DOUGH INSERT	14
<b>5. CLEANING AND MAINTENANCE</b>	
5.1 GENERALITIES AND PRODUCTS FOR CLEANING	14
5.2 CLEANING DISMOUNTED PARTS	14
5.3 REASSEMBLING THE MACHINE	14
5.4 MACHINE IDLE FOR A LONG TIME	14
<b>6. ACCESSORIES</b>	
6.1 SUPPLIED ACCESSORIES	15
<b>ALLEGATI</b>	
FIGURE	27-29
ELECTRIC DIAGRAM	28

DESIGN AND TECHNICAL DETAILS CAN BE CHANGED ALSO WITHOUT NOTICE.

## **1) INFORMATION ON SAFETIES**

### **1.1 GENERAL PRECAUTIONS**

- THE DIVIDER PPL-800VS MUST BE MANAGED BY SKILLED PERSONNEL, FAMILIAR WITH THE INSTRUCTIONS FOR USE AND SAFETY CONTAINED IN THIS MANUAL.
- IN THE CASE OF ROTATION OF THE PERSONNEL, VOCATIONAL TRAINING IS NECESSARY.
- EVEN IF THE MACHINE COMES WITH SEVERAL SAFETY SYSTEMS, AVOID SETTING THE HANDS NEAR THE MOVING PARTS.
- BEFORE THE CLEANING AND MAINTENANCE OPERATIONS, CHECK TO MAKE SURE THE MACHINE IS DISCONNECTED FROM THE MAINS.
- PERIODICALLY CHECK CABLE AND ELECTRIC ELEMENTS CONDITIONS.
- NEVER CARRY OUT REPAIRING OPERATIONS PERSONALLY, BUT APPLY ALWAYS TO SKILLED PERSONNEL.

### **1.2 MECHANICAL SAFETIES**

THE DIVIDERS WE PRODUCE AND WHICH ARE DESCRIBED IN THIS MANUAL MEET, AS FAR AS SAFETIES ARE CONCERNED, THE PRESCRIPTIONS ON THE RISKS OF MECHANICAL TYPE ISSUED BY E.E.C. 89/392 - 91/368 - 93/44 - 93/68 - 89/336 FOR THE SANITARY REGULATIONS THEY COMPLY WITH THE RULE E.E.C. 89/109.

### **1.3 ELECTRICAL SAFETIES**

THE SAFETIES AGAINST ELECTRICAL RISKS COMPLY WITH THE REGULATIONS CENELEC EN 335-2-64

ALL OUR DIVIDERS INCLUDE A LOW VOLTAGE ELECTRIC CIRCUIT AND TWO BUTTONS FOR STARTING AND STOPPING THE MACHINE.

ON THE LOW VOLTAGE CONTROL CIRCUIT IS SET A RELAY FOR RESTARTING THE MACHINE WHENEVER A FORTUITOUS LACK OF CURRENT OCCURS.

DUE TO THE PERFECT INSULATION OF ALL THE ELECTRIC ELEMENTS AND THE REMARKABLE RESISTANCE OF ALL THE MATERIALS USED, OUR MACHINES CAN BE INSTALLED TO WORK INSIDE MOIST PREMISES.

IN FACT, THEY HAVE BEEN CREATED TO WITHSTAND CLEANING THROUGH A FINE WATER SPRINKLE AS PRESCRIBED BY THE REGULATIONS CEI 70-1 FOR THE DEGREE OF PROTECTION IP54

WARNING: IN CONFORMITY WITH POINT 1.7.2. "INSTRUCTIONS ON FURTHER RISKS" CONTAINED IN THE E.E.C. REGULATIONS 80/392 AND 91/368, THESE PROTECTIONS AND SAFETIES STRICTLY COMPLY WITH THESE REGULATIONS.

WE POINT OUT HOWEVER THAT THE ABOVE MENTIONED PROTECTIONS, EVEN IF THEY SENSIBLY REDUCE BOTH THE POSSIBILITY AND EXTENT OF THE DAMAGE, DO NOT ELIMINATE FULLY THE RISK OF DAMAGE

## **2) TECHNICAL FEATURES**

TECHNICAL FEATURES OF THE SERIES OF "DIVIDERS PPL-800VS":

- POSSIBILITY OF CONTINUOUS WORK
- THEIR USE, CLEANING AND MAINTENANCE IS QUITE SAFE
- THANKS TO THEIR DESIGN AND TO THE REALIZATION OF ALL PARTS IN STAINLESS STEEL WITHOUT EDGES FOR EASY CLEANING OPERATIONS, THESE MACHINES FULLY COMPLY WITH THE MOST STRICT SANITARY REGULATIONS.

## **2.1 TABLE OF WEIGHTS AND MEASURES**

MODEL	DIMENSIONS CM.	WEIGHT KG	POWER WATT	ELECTRICAL CONNECTION	AMP.
<b>PPL-800VS MN</b>	55X79XH148	86	650	230/1/50	3,8
<b>PPL-800VS TR</b>	55X79XH148	86	650	400/3/50+N	2

CONTAINER CHARGE 30 KG DOUGH

**NOISE <70 DB**

**WARNING:** THE ELECTRICAL FEATURES OF EACH EQUIPMENT ARE PRINTED ON THE MOTOR DATA PLATE. A CHECK OF THE ELECTRIC CONNECTION IS NECESSARY BEFORE INSTALLING THE EQUIPMENT.

## **2.2 SUPPLY CONDITIONS AND DISPOSAL OF PACKINGS**

ALL THE SLICERS ARE PACKED IN A STURDY CARDBOARD BOX WITH INTERNAL SHAPED EDGES WHICH GUARANTEE THE PERFECT INTEGRITY OF THE MACHINE DURING TRANSPORT. EACH EQUIPMENT INCLUDES:

- DECLARATION OF CONFORMITY E.E.C.
- INSTRUCTIONS FOR USE AND MAINTENANCE

ALL THE PACKING COMPONENTS (CARTON, FOAM, STRAPS, AND SO ON) CAN EASILY BE DISPOSED OF AS HOUSEHOLD RUBBISH.

WHENEVER THE MACHINE IS INSTALLED IN COUNTRIES HAVING SPECIAL REGULATIONS ON PACKING DISPOSAL, THE FINAL USER MUST COMPLY WITH THE REGULATIONS IN FORCE.

THE USE OF THE WEEE SYMBOL INDICATES THAT THIS PRODUCT MAY NOT BE TREATED AS HOUSEHOLD WASTE. BY ENSURING THIS PRODUCT IS DISPOSED OF CORRECTLY, YOU WILL HELP PROTECT THE ENVIRONMENT. FOR MORE DETAILED INFORMATION ABOUT THE RECYCLING OF THIS PRODUCT, PLEASE CONTACT YOUR LOCAL AUTHORITY, YOUR HOUSEHOLD WASTE DISPOSAL SERVICE PROVIDER OR THE SHOP WHERE YOU PURCHASED THE PRODUCT.



## **3) INSTALLATION**

### **3.1 SETTING THE MACHINE**

THE MACHINE CONNECTION AND THE SETTING AT WORK MUST BE MADE BY SKILLED PERSONNEL.

**WARNING:** BOTH THE SYSTEM AND LOCATION WHERE THE EQUIPMENT HAS TO BE SET MUST COMPLY WITH THE REGULATIONS FOR THE ACCIDENT PREVENTION AND ELECTRICAL REGULATIONS "CEI" IN FORCE.

**THE MANUFACTURER DECLINES ANY AND ALL RESPONSIBILITY FOR DIRECT OR INDIRECT DAMAGES WHICH MAY ENSUE FOR NON-COMPLIANCE WITH THE ABOVE MENTIONED REGULATIONS.**

SET THE EQUIPMENT ON A WIDE, LEVELLED, DRY AND FIXED TABLE, FAR FROM HEAT SOURCES AND WATER SPRAYS, AND WITH 80 CM. GROUND CLEARANCE, AT A MINIMUM DISTANCE OF 20 CM FROM THE WALL.

## **3.2 ELECTRIC CONNECTIONS**

THE EQUIPMENT IS SUPPLIED WITH AN ELECTRIC CABLE TO BE CONNECTED TO A MAGNETO-THERMIC MAIN SWITCH WHICH STOPS THE MACHINE WHEN THE OPERATOR COMES IN FORTUITOUS CONTACT WITH THE ROTATING ELEMENTS.

IT IS IMPERATIVE THAT THE EQUIPMENT IS WELL GROUNDED ACCORDING TO THE REGULATIONS IN FORCE

**THE MANUFACTURER DECLINES ANY AND ALL RESPONSIBILITY FOR DIRECT AND INDIRECT DAMAGES WHICH MAY ENSUE FOR NON-COMPLIANCE WITH THE REGULATIONS IN FORCE.**

ALL THE DIVIDER ARE MANUFACTURED 3- PHASE **V.400/3/50+N** HZ. OR OR SINGLE PHASE **V.230/1/50**

WHENEVER THE VOLTAGE DIFFERS FROM THE ABOVE MENTIONED ONES, PLEASE APPLY TO THE MANUFACTURER, OR THE AUTHORIZED DISTRIBUTOR. (Fig.1-2)

**ATTENTION!** BEFORE THE FINAL CONNECTION OF THE MACHINE TO THE MAIN LINE, WHEN THE MACHINE IS 3PHASE CONNECTION IT IS NECESSARY TO CHECK THE ROTATION WAY OF THE KNIFE. (TIME WAY)

IF THE ROTATION IS NOT TIME WAY IT IS NECESSARY TO CHANGE IN CONNECTING PLUG TWO OF THE 3 WIRES. (Fig.3)

## **3.3 SAFETY MEASURES AND TRAINING THE FINAL USER**

THE SKILLED PERSONNEL IN CHARGE OF THE INSTALLATION AND ELECTRIC CONNECTIONS IS RESPONSIBLE OF THE TRAINING OF THE FINAL USER, WHICH MUST ALSO BE INFORMED ON THE SAFETY MEASURES TO COMPLY WITH.

THIS INSTRUCTION MANUAL COMES WITH EACH EQUIPMENT.

## **4) USE OF THE EQUIPMENT**

THE DIVIDER PPL-800VS HAVE BEEN STUDIED FOR THE PRODUCTION OF DIFFERENT PORTIONS FROM 20 GR UP TO 300 GR.

### **4.1 CONTROLS**

ALL CONTROLS ARE IN FRONT OF THE OPERATOR. THE GREEN BUTTON IS FOR START AND THE RED ONE FOR STOP (Fig.4)

### **4.2 REGULATION OF THE PORTION WEIGHT**

TO OBTAIN THE DESIRED WEIGHT IT IS NECESSARY TO REGULATE THE PHOTOELECTRIC CELL AS FOLLOWS:

(Fig.5)

1. UNSCREW THE HANDLE "A".
2. TURN THE RING "B" UP TO THE CORRECT DISTANCE OF THE PHOTOELECTRIC CELL WITH THE BLACK LINE PRINTED ON THE WALL
3. SCREW ON THE HANDLE "A".

### **4.3 CHANGE OF THE EXTRUSION CONE**

BEFORE STARTING THIS OPERATION IT IS IMPORTANT TO ASSURE THAT THE MAIN SWITCH IS OFF OR THE PLUG DISCONNECTED AND THE GREEN LAMP IS OUT.

1. OPEN THE PLASTIC PROTECTION IN FRONT OF THE OPERATOR
2. UNSCREW THE BLADE FIXING HANDLE AND REMOVE IT (Fig. 6)
3. UNSCREW THE TWO HANDLES AND REMOVE THE CONE TURNING CLOCKWISE (Fig.7)

TO ASSEMBLE THE MACHINE FOLLOWS ALL OPERATION ON CONTRARY

#### **4.4 DOUGH INSERT**

THE DOUGH (MAX 30KG) HAVE TO BE INSERT IN THE CONTAINER IN THE TOP OF THE MACHINE OPENING THE GLASS COVER. (Fig.3)

### **5) CLEANING AND MAINTENANCE OPERATIONS**

#### **5.1 GENERALITIES AND PRODUCTS FOR CLEANING**

**BEFORE CARRYING OUT ANY CLEANING OR MAINTENANCE OPERATIONS, CHECK TO MAKE SURE THAT THE MAINS SWITCH BE OFF AND THE SUPPLY PLUG DISCONNECTED FROM THE MAINS.** ACCURATELY CLEAN THE EQUIPMENT EVERY DAY FOR A CORRECT OPERATION AND LIFE OF THE EQUIPMENT.

STAINLESS STEEL WITHSTANDS THE ACTION OF THE OXYGEN PRESENT IN THE AIR, AND THIS IS THE REASON WHY ALL OUR MACHINES ARE MANUFACTURED IN STAINLESS STEEL AISI 304 (18/10) WITH PATENTED SURFACE TREATMENT THAT GRANTS HIGH RESISTANCE TO CORROSION. SOME SUBSTANCES HOWEVER MAY CAUSE SERIOUS DAMAGES.

CLEAN THE SURFACES WITH WATER AND SOAP, ALCOOL, DETERGENTS WITHOUT ABRASIVES OR SUBSTANCES BASED ON CHLORINE OR SODA (CHLORINE WATER, MURIATIC ACID).

NEVER USE ABRASIVE, STEEL WOOL, OR SIMILAR PRODUCTS AS THEY MAY BRING DAMAGES TO THE PAINT, THE COAT, OR THE MACHINE BODY.

**FOR CLEANING, USE NON-TOXIC PRODUCTS AND ONES THAT GUARANTEE THE BEST HYGIENE.**

#### **DO NOT CLEAN THE REMOVABLE PARTS IN DISH MACHINE.**

#### **5.2 CLEANING OF THE REMOVABLE PARTS**

FOR THE CLEANING OF THE REMOVABLE PARTS FOLLOWING THE FOLLOWING INSTRUCTION:

1. TAKE OFF THE PLUG FROM THE MAIN POWER
2. OPEN THE PLASTIC COVER
3. UNSCREW AND REMOVE THE KNIFE HANDLE AND THE KNIFE
4. UNSCREW THE HANDLES AND REMOVE THE CONE
5. UNSCREW THE HANDLE AND REMOVE THE CENTRAL SPIRAL

#### **ALL PARTS CAN BE WASHED IN WARM WATER**

#### **5.3 RIASSEMBLING OF THE MACHINE**

TO ASSEMBLE AFGAIN THE MACHINE FOLLOWING ALL INSTRUCTIONS OPPOSITE

#### **5.4 MACHINE IDLE FOR A LONG TIME**

SHOULD THE MACHINE BE IDLE FOR A LONG TIME, DISCONNECT THE MAIN WALL SWITCH AND CLEAN THE MACHINE AND ITS ACCESSORIES ACCURATELY. USE WHITE VASELINE OIL (OR SIMILAR PRODUCTS) TO PROTECT ALL THE MACHINE'S ELEMENTS.

THESE PRODUCTS, MAINLY MADE UP OF OILY AND DETERGENT SUBSTANCES, AND NOW AVAILABLE IN SPRAY CYLINDERS FOR EASY APPLICATION, BESIDES GIVING A GLOSSY ASPECT TO THE STEEL, PREVENT MOISTURE AND DIRT FROM GETTING INSIDE THE MACHINE, HENCE, ITS CORROSION.

WE ADVISE COVERING THE MACHINE WITH A NYLON (OR SIMILAR) CLOTH.

## **6) ACCESSORIES**

### **6.1 SUPPLIED ACCESSORIES**

<b>EXTRUSION CONE DIMENSIONS</b>			
	<b>Ø DIAMETER CONE mm.</b>	<b>MINIMUM WEIGHT Gr.</b>	<b>MAXIMUM WEIGHT Gr.</b>
	45	20/40	150
	70	70/80	300



## 7) BILDER

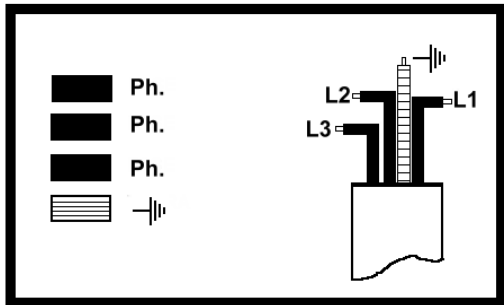

Fig. 1

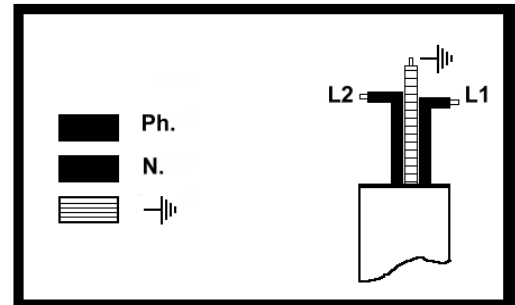

Fig. 2



Fig. 3

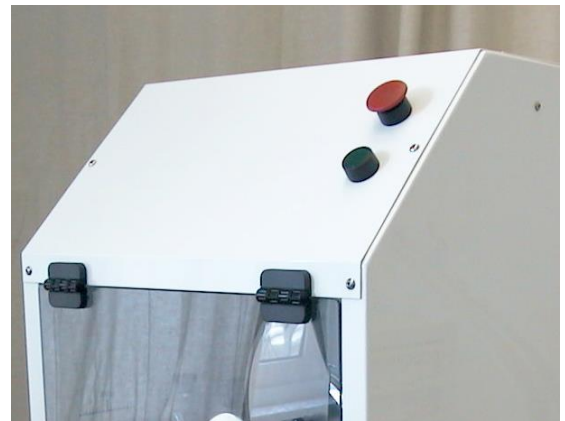

Fig. 4

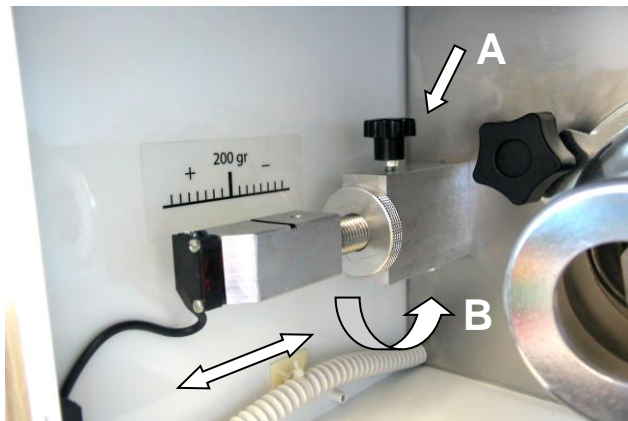

Fig. 5

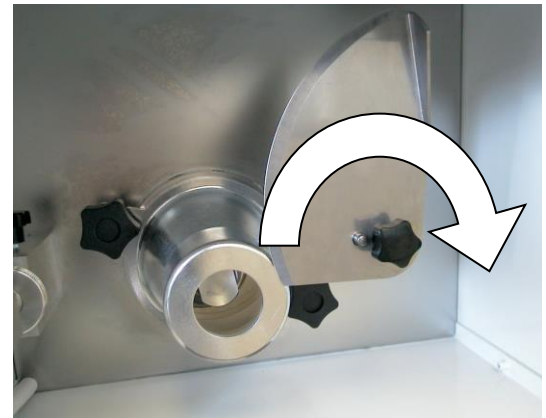

Fig. 6

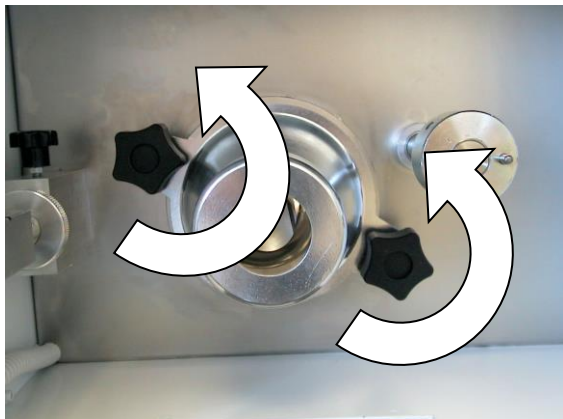
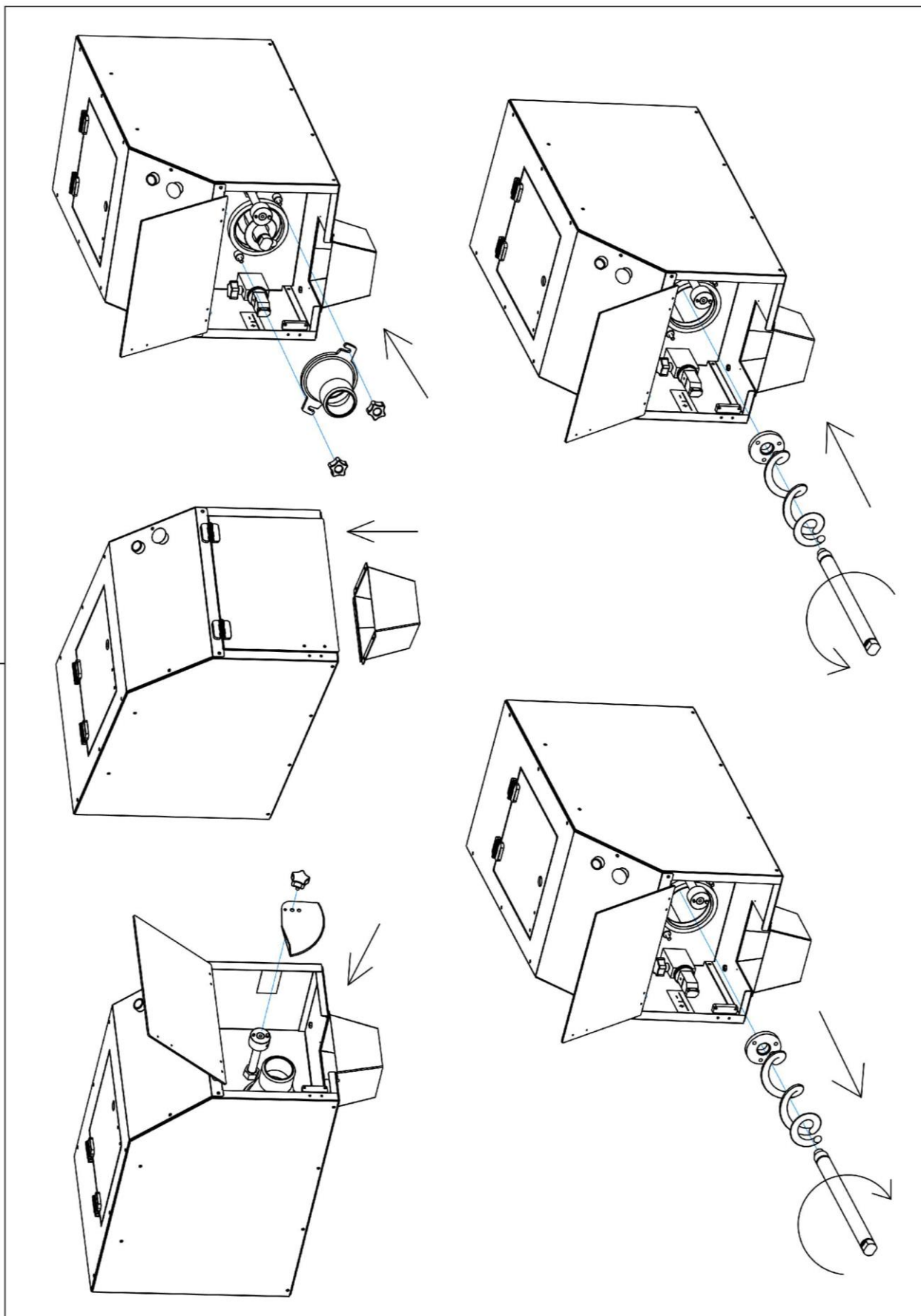

Fig. 7



ALL THE PACKING COMPONENTS (CARTON, FOAM, STRAPS, AND SO ON) CAN EASILY BE DISPOSED OF AS HOUSEHOLD RUBBISH.

WHENEVER THE MACHINE IS INSTALLED IN COUNTRIES HAVING SPECIAL REGULATIONS ON PACKING DISPOSAL, THE FINAL USER MUST COMPLY WITH THE REGULATIONS IN FORCE.

THE USE OF THE WEEE SYMBOL INDICATES THAT THIS PRODUCT MAY NOT BE TREATED AS HOUSEHOLD WASTE. BY ENSURING THIS PRODUCT IS DISPOSED OF CORRECTLY, YOU WILL HELP PROTECT THE ENVIRONMENT. FOR MORE DETAILED INFORMATION ABOUT THE RECYCLING OF THIS PRODUCT, PLEASE CONTACT YOUR LOCAL AUTHORITY, YOUR HOUSEHOLD WASTE DISPOSAL SERVICE PROVIDER OR THE SHOP WHERE YOU PURCHASED THE PRODUCT.

