



MOD: MAX/609-BB

Production code : VFP604B-DMD

12/2024

Instruction manual:

Model..... VRP series 304-404-604-804

Model..... VFP series 304-404-604-804

Model..... RV series 304-404-604-804

Model..... MV series 304-404-604-804

Model.....CHC series304-404-604-804

Contents

Safety Tips 24

Section 1 | Opening of packaging 26

Section 2 | Positioning and installation 27

Section 3 | First ignition and use 28

Section 4 | Troubleshooting and alarm alerts 31

Section 5 | Connex 2.x application 33

Section 6 | Routine maintenance 35

Section 7 | Disposal 37

Section 8 | Warranty conditions 38

Dear customer,

Congratulations on purchasing this product.

Take a few minutes before you start using the appliance and read the following operating instructions.

*You can find the **rating label** for the main technical information in the Declaration of Conformity and on the product itself.*



You will find the declaration of conformity
inside the packaging

Safety tips

IMPORTANT: For your own safety, read the manual carefully before installing or using this product. Keep this manual for future reference.

Consult the local and national standards to ensure compliance with the following:

1. Legislation on health and safety at work
2. Fire precautions
3. IEE wiring rules
4. Building regulations
5. **DO NOT** use the appliance outdoors.
6. **DO NOT** attempt to repair the appliance yourself.
7. **DO NOT** use damaged appliances. If in doubt, consult the assistance service.
8. **DO NOT** use electrical devices inside the appliance (e.g. heaters, ice cream makers, etc.), unless they are of the type recommended by the manufacturer.
9. Keep the ventilation openings in the appliance housing or in its integrated structure free from obstructions.
10. **DO NOT** use mechanical devices or other means to accelerate the process of defrosting, other than those recommended by the manufacturer.
11. **DO NOT** damage the refrigerant circuit.
12. **DO NOT** stand or lean on the base, drawers or doors.
13. **DO NOT** allow grease or oil to come into contact with the plastic components or door gasket. Clean immediately in case of contact.
14. This unit may be used by a child over 8 years of age and by persons with reduced physical, sensory or mental capabilities or lack of experience and knowledge, provided that the latter have been given supervision or instructions concerning how to use the appliance safely and understand the dangers involved (for the European market).
15. **DO NOT** let children play with the appliance.
16. Cleaning and utility maintenance must not be carried out by unsupervised children.
17. **DO NOT** place combustible, explosive or volatile items, corrosive acids or alkali or liquids inside the appliance.
18. **DO NOT** use this appliance to store medicines.

19. **DO NOT** use jet/pressure washers to clean the appliance.
20. **DO NOT** allow children to play with the packaging and dispose of the plastic bags safely.
21. Bottles containing a percentage of alcohol must be sealed and placed vertically in the refrigerator.
22. Always carry, store and handle the appliance in a vertical position and move it using the base of the appliance.
23. Always turn off and disconnect the power from the unit before cleaning.
24. If damaged, the cable must be replaced by the manufacturer, by its service agent or similarly by qualified personnel in order to avoid hazards.
25. For indoor use only. Not suitable for installation in an area where it could be reached by a jet of water. It should not be cleaned with a jet of water.
26. To ensure safe operation, make sure the appliance is configured and connected as described in the user manual.
27. Any repair and work on the appliance must be carried out by the customer service department/qualified technician.
28. The key of the electrical panel must be kept out of the reach of children and users.
29. **DO NOT** store explosive objects, such as spray cans containing flammable propellant, inside the device.

Section 1 | Opening of packaging

Upon receipt of the appliance, immediately check that there has been no transportation damage. Remove the packaging by lifting the cardboard box upwards and removing the pallet. Both can be 100% reused.

Make sure that the accessories of the chosen configuration are present inside the product. In the event of transportation damage, your reservations to the driver must be documented immediately; within a period of three days. These reservations must be confirmed by registered letter with return receipt to the driver with a copy for information to the company or authorised distributor. Before use, if present, remove the moisture-absorbing sachet present inside the product.

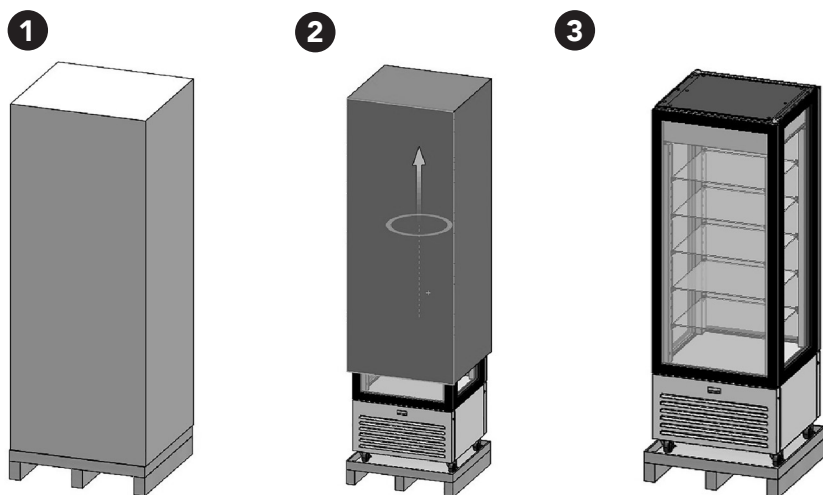

ATTENTION:

No packaging components must ever be dispersed in the environment. If the appliance has been transported lying down, it is essential to inform the installer. All installation and extraordinary maintenance operations must be carried out by qualified technical personnel.

Section 2 | Positioning and Installation

The installer must check the fire prevention requirements (remember that the display case works with R290 Propane Gas) and position the machine in full compliance with the accident-prevention laws and current regulations.

This appliance must be placed possibly on a flat and solid floor to reduce noise and vibration.

As the appliance uses an air condenser, this feature must be taken into account during positioning and keeping the front inlet side of the cooling air unobstructed; in addition, it must be kept at least 20 cm from walls or any other equipment on the air outlet side in order to obtain optimum performance. Avoid placing the machine in closed or poorly ventilated places, exposed directly to sunlight and in any case keep it away from any heat sources. The electrical connection is made by connecting the schuko socket to the mains. Check that the power supply and voltage used comply with the data shown on the plate. After installation, the plug must be accessible. Connect and disconnect the plug correctly. When inserting the plug, make sure it is fully engaged. When disconnecting, hold the body of the plug. Never pull the power cord directly.



Section 3 | First ignition and use

Once connected to the 220V/50Hz mains, simply press the on/off key on the instrument. The setpoint according to the model will be pre-set at the company. Below are the instructions for any change in the setpoint or other operating parameters. *We advise you to carry out the activities with the assistance of a qualified technician.*

LEFT SIDE ICONS:

COOLING,
VENTILATION,
HEATING/DEFROST,
LIGHT

RIGHT SIDE ICONS:

UNIT OF MEASURE-
MENT CONNECTED
TO THE BLUETOOTH
ROUTER (not active)
CONNECTED TO THE
CLOUD



DUAL DISPLAY, KEYS > LIGHT MENU UP DW ON/OFF
- White LED upper display, blue LED lower display

2.0 MENU

Accessed via the MENU key; scrolled via the UP/DW keys, exited via the ON/OFF key.

M1: SET TEMPERATURE DETERMINED

From M1/SET press the MENU key; the set determined appears. Use the UP/DW keys to set the value. Confirm with MENU.

M2: START A DEFROST

From M2/DEFR press the MENU key. The command is refused if the conditions for defrosting do not exist. The double evaporator configuration allows the selection of defrost on the evaporator E1 or on the evaporator E2 or on both (FULL) whose selection takes place by successive presses of the MENU key.

M3: SET THE HIGH TEMPERATURE LIMIT

From M3/HI press the MENU key and use the UP/DW keys to set the new value. Confirm with MENU. *To be carried out with the assistance of a qualified technician.*

M4: SET THE LOW TEMPERATURE LIMIT

From M4/LO press the MENU key and use the UP/DW keys to set the new value. Confirm with MENU. *To be carried out with the assistance of a qualified technician.*

M5: SHOW THE LIST OF EVENTS

From M5/LIST press the MENU key; if there are no events it displays "not" and exits, otherwise the upper display shows the alarm index, the lower one the

number of events. If it is a fault, by pressing MENU, the upper display shows the fault index, the lower one the fault type; by pressing MENU again, the time, day, month and year of event start are displayed in sequence. If it is an alarm, by pressing MENU, the upper display shows the peak temperature, the lower one shows the type (see tables on page 10). By pressing MENU again the upper display shows the duration in minutes, the lower display shows in sequence the time, the day, the month and the year of the event start.

M6: DISPLAYS THE VALUES OF THE PROBES

From M6/INFO press the MENU key: the upper display shows the value, the lower one the type of variable. The variables are selected using the UP/DW keys. *To be carried out with the assistance of a qualified technician.*

M7: CONFIGURE LOWER DISPLAY

From M7/MODE press the MENU key and select modes 1 to 12 using the UP/DW keys. Confirm with MENU. 1: RTC time; 2: action (*); 3: rpm compress.; 4: Rh% 5: Temperature S2. 6: Temperature S3. 7: Setpoint on upper display, time on lower display. 8: Humidity set. 9: Temperature set. 10: not used. 11: not used. 12: Program active. (*) LABELS ACTIONS: COOL=cool; PAUS=pause DEFR=defrost; HEAT=heat; DRIP=drip; DRY=dehumidify; WARM= humidify; ECO=energy saving state. *To be carried out with the assistance of a qualified technician.*

M8: CLEAR THE ALARM LIST

From M8/ERAS the long press of the MENU key confirms the deletion of the event list and "DONE" appears.

M9: PROGRAM PARAMETERS

To be carried out with the assistance of a qualified technician.

M10: SET THE CLOCK

Setting the clock causes total deletion of the thermoregistration data.

From M10 /DATE press the MENU key: the time appears with the unit of measurement in the top right and the HOUR label. Change the value using the UP/DW keys and confirm with the MENU key; then the minutes, day, month and year appear whose values will be modified in the same way using the UP/DW keys confirming with the MENU key.

M11: SET USER AND SERVICE PASSWORD

From M11/PASS press the MENU key: using the UP/DW keys select USER or SERVICE which are respectively the passwords for the protected menus (M1-M3-M4-M8-M15-M16) and for access to the M9 or RST configuration menu; the RST submenu allows deletion of the USER password if the SERVICE password is zero or setting of the SERVICE password if it is different from zero. If the password has not been set, SET/PASS appears for a few seconds then 000/

PASS. Set your password using the UP/DW keys and confirm with MENU. If the password is present, 000/PASS appears. To change it, use the UP/DW keys to set its previous value and confirm with MENU; if it is correct, SET/PASS appears for a few seconds then the value of the previous password; set the new value with the UP/DW keys and confirm with MENU. If it has been set incorrectly, Err appears and then exits the menu.

M12: SET NETWORK PARAMETERS

To be carried out with the assistance of a qualified technician.

M13: SET LIGHT OFF TIME

From M13/LOF by pressing the MENU key, the display will show OFF if a compartment light off time has never been set or will show the off time. Use the UP/DW keys to set the light off time from 1 to 24, confirming with MENU. After the DONE message, it exits the menu.

M14: SET THE START TIME OF THE REFRIGERATION UNIT

From M14/COOL by pressing the MENU key, the display shows OFF if a refrigerator unit power-on time has never been set or displays the power-on time. Using the UP/DW keys set the power on time from 1 to 24, confirming with MENU. After the DONE message, it exits the menu.

M15: SET HUMIDITY

This menu is only accessible if the humidity function is enabled. From M15/RH press the MENU key: the set humidity appears. Use the UP/DW keys to set the value. Confirm with MENU. *To be carried out with the assistance of a qualified technician.*

M16: SET THE SECOND TEMPERATURE

This menu is accessible if the function is provided in the refrigerator unit. From M16/SET2 press the MENU key: the setpoint of the second zone appears. Use the UP/DW keys to set the value. Confirm with MENU. *To be carried out with the assistance of a qualified technician.*

M19: CONFIGURE THE LIGHTS MODULE.

If such an option is available.

Note:

Manual defrosting can be performed with parameter M2.

However, remember that in all the models, except the negative static window, defrosting is automatic.

ATTENTION:

Do not use mechanical devices or other means to accelerate the defrosting process, other than those recommended by the manufacturer.

Section 4 | Troubleshooting and alarm alerts

Below you will find a number of simple problems and how to resolve them if they arise:

PROBLEM	POTENTIAL PROBLEM	ACTION TO RESOLVE THE PROBLEM
The appliance does not work	The unit is not turned on	Check that the unit is properly connected and switched on
	The plug and/or cable is damaged	Contact your representative or a qualified technician
	The fuse in the plug is blown	Replace the fuse (UK Plug)
	Power supply	Check the power supply
The appliance turns on, but the temperature is too high / low	Too much ice on the evaporator	Defrost the appliance
	Condenser blocked by dust	Contact your representative or a qualified technician
	The doors do not close properly	Check that the doors are closed and not damaged
	The appliance is located near a source of heat or air flow to the condenser has been interrupted	Move the refrigerator to a more suitable place
	Ambient temperature too high	Increase ventilation or move appliance into a cooler position
	Unsuitable food is being stored in the appliance	Remove any food hot products or excessive blockages to the fan
	The appliance is overloaded	Reduce the quantity of food stored in the appliance
The appliance makes an unusually loud noise	Loose nut / screw	Check and tighten all the nuts and screws
	The appliance has not been installed in a flat or stable position	Check the installation position and, if necessary, change it
The appliance leaks water	The appliance is not in a level position	Adjust the screw base to level the appliance (if applicable)
	Exhaust outlet is blocked	Clear the exhaust outlet
	The movement of water towards the outlet is obstructed	Clean the floor of the appliance (if applicable)
	The water tank is damaged	Contact your representative or a qualified technician
	The drip drawer is too full	Empty the drip drawer (if applicable)

In the event of anomalies or critical situations, the display shows several indications. Below are the **decodes** of each of them:

TABLE OF EVENTS IN PROGRESS:

ALARM DISPLAYED	POTENTIAL PROBLEM	ACTION TO RESOLVE PROBLEM
Hi	High temperature pre-alarm	Check that: the door is tightly closed; the appliance is not too close to heat sources; there is no ice on the evaporator (to be defrosted); condenser to be cleaned; hot food has been displayed in the appliance; faulty evaporator fan
Hi ALARM	High temperature alarm in progress	
Lo	Low temperature pre-alarm	Check: the set determined; possible temperature probe malfunction; check low temperature limits set
Lo ALARM	Low temperature alarm in progress	
LoEV ALARM	Evaporation low temperature	
HiCn ALARM	Condensation high temperature	Check: condenser cleanliness; ambient temperature excessively high
dEFr flashing	Defrost in progress	Wait for defrost time
dEFr ALARM	Defrost time-out	Excessive formation of ice on the evaporator; check: closing of the door and state of the gaskets; overly wet food inserted inside; doors opened too frequently; possible defrost malfunction

Sezione 5 | Connex 2.x Application

Once the refrigerator is installed, the FLEX controller can be managed through the Connex 2.x application, which can be downloaded for free from the Play Store or Apple Store using access via the QR Codes printed on the sheet in each refrigerator. The application allows the management of refrigeration units via Internet connection following user registration.

Registration:

After the presentation pages, the registration page appears. All fields must be completed following the step-by-step instructions. In the Token field, the code indicated on the sheet with the QR Codes must be entered.

Once the devices are connected, the data compilation page will appear to obtain the Test Report, useful for obtaining the tax benefits provided for by the Transition 4.0 plan (Only valid for the Italian State).

The image displays the registration and connection process for the Connex 2.x application. On the left is the registration form, which includes fields for Email, Password, Confirm password, Token, Company name, Address, and City, followed by a 'REGISTRATI' button. A line connects the 'Token' field to the 'TOKEN' field on the 'CONNECT YOUR FRIDGE' screen. Below the registration form is the text 'CONNETTITI AL FRIGORIFERO'. The 'CONNECT YOUR FRIDGE' screen (top right) features a Wi-Fi icon, two QR codes for Android and iOS, the text 'i4.0', and the registration details: 'TOKEN: K9cLhTg5' and 'Fridge: FRIGO1 - S/n: 499'. The bottom right shows another 'CONNECT YOUR FRIDGE' screen with an 'IoT' cloud icon, two QR codes, the text 'i4.0', and the recovery details: 'RECOVERY CODE: eTeVVbvl' and 'S/n: 135'.

Registration Form Fields:

- Email
- Password
- Conferma password
- Token
- Nome azienda
- Indirizzo
- Città

REGISTRATI

CONNETTITI AL FRIGORIFERO

CONNECT YOUR FRIDGE

QR CODES: ANDROID, iOS

i4.0

TOKEN: K9cLhTg5

Fridge: FRIGO1 - S/n: 499

CONNECT YOUR FRIDGE

QR CODES: ANDROID, iOS

i4.0

RECOVERY CODE: eTeVVbvl

S/n: 135



You can find the **Connex** application, for refrigerator management on PlayStore and Apple Store.



Section 6 | Routine maintenance

Cleaning and ordinary maintenance can only be performed by non-specialist personnel by carefully following the instructions below.

Before starting any operation, disconnect the power supply to the appliance. Wash the inside of the cell with water and neutral detergents, without jets of water and without abrasive materials, then dry thoroughly and position the grids as required (perform the afore-mentioned operation at least once every six months).

Clean the condenser periodically, for a maximum of 3 months, using a brush or a vacuum cleaner only after removing the plug from the mains and taking care not to bend the aluminium fins.

To access the condenser, unscrew the front panel, taking care not to excessively pull the electrical connections. Removing dust or other foreign bodies allows for better air circulation and improved performance. Finally reassemble the panel, being sure to tighten the fixing screws.

ATTENTION:

The condenser has sharp edges; wear protective gloves when cleaning. It is also mandatory not to remove the safety devices and guards during routine maintenance.

OTHERWISE, THE MANUFACTURER DECLINES ANY RESPONSIBILITY FOR DAMAGE OR ACCIDENTS CAUSED BY FAILURE TO COMPLY WITH THE ABOVE OBLIGATION.

Note: NO SHARP OR ABRASIVE BODIES, NO SOLVENTS OR THINNERS

In case of extraordinary maintenance on the refrigeration system, it is possible to remove the rear panel; **in any case these operations may only be carried out by refrigerator specialists or by authorised technicians** and in any case after disconnecting the plug from the power supply. Clean the seals only with a soft cloth and water. Do not use aggressive or corrosive products.







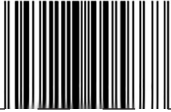

**ATTENTION: RISK OF FIRE AND EXPLOSION WITH
FLAMMABLE REFRIGERANT R600a/ R290**

Below is an example of a table with the technical data of the product that you will find on the rating label present in the declaration of conformity and on the product itself.

The technical data indicated are: type and quantity of gas, power and voltage, etc.

Example of a rating label:

<div>PRODUCT MODEL</div>																				
<div><div><div>CODE</div></div><div><div>SERIAL NUMBER</div></div></div>		<div>TECHNICAL PARAMETERS</div> <table><tr><td>CLIMATE CLASS</td><td rowspan="10">DETAILS</td></tr><tr><td>TEMPERATURE</td></tr><tr><td>REFRIGERANT</td></tr><tr><td>REF. CHARGE</td></tr><tr><td>RATED FREQUENCY</td></tr><tr><td>RATED VOLTAGE</td></tr><tr><td>RATED CURRENT</td></tr><tr><td>RATED POWER</td></tr><tr><td>LAMP POWER</td></tr><tr><td>NET WEIGHT</td></tr><tr><td>NET CAPACITY</td><td></td></tr><tr><td>MAX SHELF LOAD</td><td></td></tr><tr><td>FOAMING AGENT</td><td></td></tr></table>		CLIMATE CLASS	DETAILS	TEMPERATURE	REFRIGERANT	REF. CHARGE	RATED FREQUENCY	RATED VOLTAGE	RATED CURRENT	RATED POWER	LAMP POWER	NET WEIGHT	NET CAPACITY		MAX SHELF LOAD		FOAMING AGENT	
CLIMATE CLASS	DETAILS																			
TEMPERATURE																				
REFRIGERANT																				
REF. CHARGE																				
RATED FREQUENCY																				
RATED VOLTAGE																				
RATED CURRENT																				
RATED POWER																				
LAMP POWER																				
NET WEIGHT																				
NET CAPACITY																				
MAX SHELF LOAD																				
FOAMING AGENT																				
<div><div></div><div></div><div></div><div></div></div>																				
<div>WEEK OF PRODUCTION</div> <div>DATE</div>		<div>MADE in ITALY</div>																		

Section 7 | Disposal

Subject: Italian Legislative Decree no. 151 of 25/07/2005 (ROHS - RAEE), implementation of directives 2002/95/EC, 2002/96/EC and 2003/108/EC, relating to the reduction of the use of hazardous substances in electrical and electronic equipment, as well as waste disposal (O.J. of 29-07-2005 no. 175 of - O.S. no. 135)

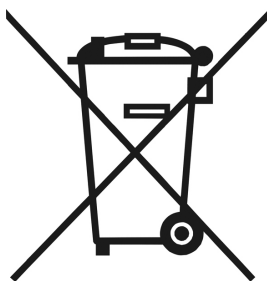

Correct disposal of the product (electrical and electronic waste) (Applicable in European Union countries and in those with separate collection systems). The above mark, found on the product or on its documentation, indicates that the equipment must not be disposed of with other household waste at the end of its life cycle. To prevent possible harm to the environment or to human health caused by inappropriate waste disposal, the user is encouraged to separate this product from other types of waste and to recycle it responsibly to promote the sustainable reuse of material resources. Domestic users should contact the reseller from whom they purchased the product or the relevant office in their area to obtain all information about waste sorting and recycling of this type of product. Business users are encouraged to contact their supplier and check the terms and conditions of the purchase agreement. This product must not be disposed of together with other commercial waste. For the incorrect disposal of WEEE-marked products, financial penalties are applicable to the non-complying user.

Section 8 | Warranty conditions

The equipment is covered by a warranty of 12 months from the date of purchase (excluding electrical parts). Any spare parts supplied under warranty will be returned free of charge to our warehouse.

In case of supplies of material under warranty/replacement, the material itself will only be supplied/replaced after the return of the defective material covered by warranty. The manufacturer declines all responsibility in the event of improper use of the appliance. Installation must only be carried out by a specialist technician. For any technical problems and any requests for intervention or assistance, it is necessary to contact only your authorised dealer or assistance centre. The necessary information for the dealer or assistance centre can be found on the CE plate.