

MOD : E17/GPLP2-HP-230/3-

Production code : 373301



Modular Cooking Range Line ECO 70 Electric Grill Top HP 800mm

ITEM # _____

MODEL # _____

NAME # _____

SIS # _____

AIA # _____

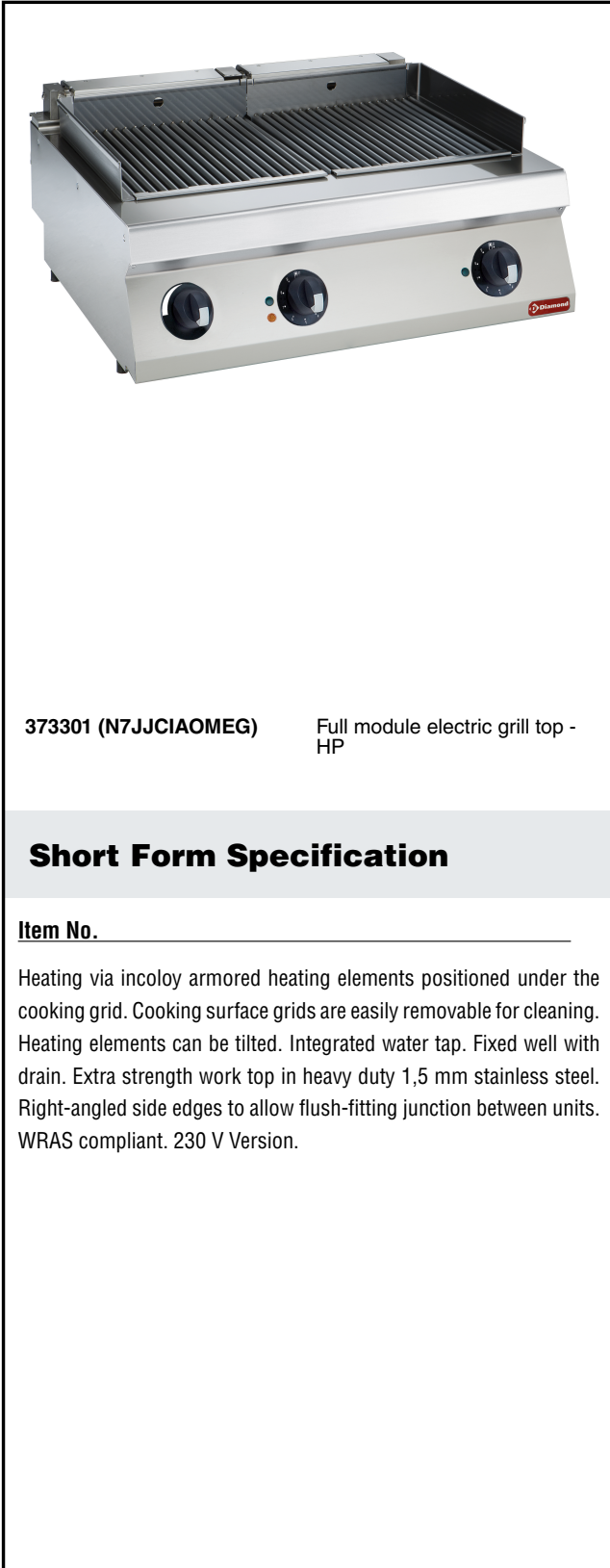

373301 (N7JJCIAOMEG) Full module electric grill top - HP

Short Form Specification

Item No. _____

Heating via incoloy armored heating elements positioned under the cooking grid. Cooking surface grids are easily removable for cleaning. Heating elements can be tilted. Integrated water tap. Fixed well with drain. Extra strength work top in heavy duty 1,5 mm stainless steel. Right-angled side edges to allow flush-fitting junction between units. WRAS compliant. 230 V Version.

Main Features

- Top configuration allows installation on ambient base.
- Incoloy armoured heating elements positioned under the cooking grid.
- Each bank of elements has an independent power regulation through a control knob.
- Power indicator light.
- Heating elements tilt 90° for easy cleaning.
- Removable 2mm thick steel U-shaped grids for fast heating of cooking surface.
- Fixed well with drain to collect residual cooking juices and grease.
- Large drain protected by overflow and filter.
- Water must be added to well before operation.
- Water filling tap with knob control.
- Removable stainless steel deflectors to recuperate heat and reduce cooking time.
- Led warning indicator to give an alarm when well is empty.
- Stainless steel splash guards on sides of cooking surface. Splash guards can be easily removed for cleaning.
- Top configuration can be installed on refrigerated / freezer base with limited layout options.
- Suitable for countertop installation.

Construction

- Model has right-angled side edges to allow flush fitting joints between units, eliminating gaps and possible dirt traps.
- One piece pressed 1.5 mm work top in Stainless steel.
- All exterior panels in Stainless Steel with Scotch Brite finishing.
- Unit is 700mm deep to give a larger working surface area.

Included Accessories

- 1 of SCRAPER FOR HP ELECTRIC GRILL PNC 206436

Optional Accessories

- JUNCTION SEALING KIT PNC 206086
- SUPPORT FOR "BRIDGE" SYSTEM 800 MM PNC 206137
- SUPPORT FOR "BRIDGE" SYSTEM 1000 MM PNC 206138
- SUPPORT FOR "BRIDGE" SYSTEM 1200 MM PNC 206139
- SUPPORT FOR "BRIDGE" SYSTEM 1600 MM PNC 206141
- FRONTAL HANDRAIL 800 MM PNC 206167
- FRONTAL HANDRAIL 1200 MM PNC 206191
- FRONTAL HANDRAIL 1600 MM PNC 206192
- SIDE HANDRAIL-RIGHT/LEFT SIDE-700 LINE PNC 206240
- 2 SIDE COVERING PANELS H=250-D=700 PNC 206320
- SCRAPER FOR HP ELECTRIC GRILL PNC 206436
- DRAIN EXTENTION FOR HP ELECTRIC GRILL PNC 206437

APPROVAL: _____



Modular Cooking Range Line ECO 70 Electric Grill Top HP 800mm

Front

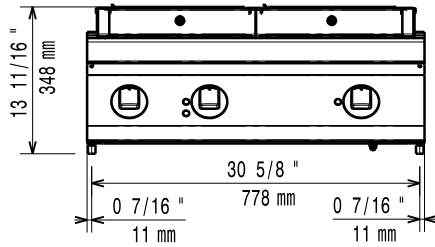

Side

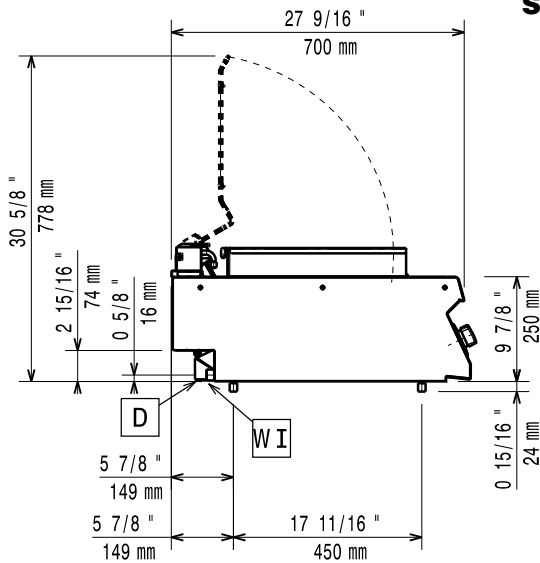

- D** = Drain
- EI** = Electrical inlet (power)
- EQ** = Equipotential screw
- WI** = Water inlet

Top

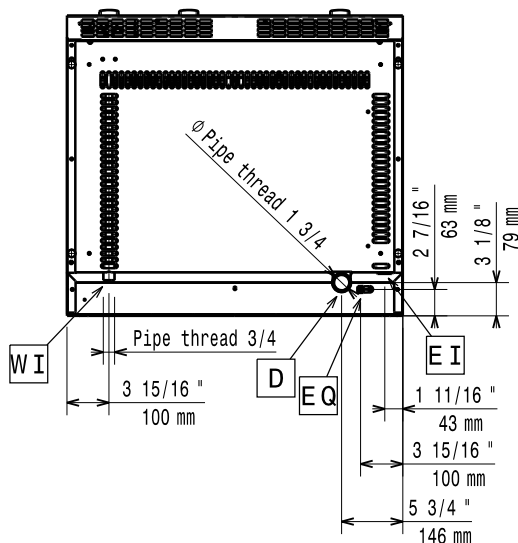

Electric

Supply voltage:
373301 (N7JJCIAOMEG) 230 V/3N ph/50/60 Hz
Electrical power max.: 7.5 kW
Predisposed for:

Key Information:

Cooking surface width: 705 mm
Cooking surface depth: 400 mm
External dimensions, Width: 800 mm
External dimensions, Depth: 700 mm
External dimensions, Height: 250 mm
Net weight: 75 kg
Shipping weight: 75 kg
Shipping height: 540 mm
Shipping width: 900 mm
Shipping depth: 820 mm
Shipping volume: 0.4 m³

If appliance is set up either next to or against temperature sensitive furniture or similar, a safety gap of approximately 150 mm should be maintained or some form of heat insulation fitted.

Certification group: HEG7E2



Modular Cooking Range Line
ECO 70 Electric Grill Top HP 800mm

The company reserves the right to make modifications to the products without prior notice. All information correct at time of printing.